

Specifications

| | | 55VH7B |
|--------------------------------|--|---|
| PANEL | Screen Size | 55 |
| | Panel Technology | IPS |
| | Aspect Ratio | 16 : 9 |
| | Native Resolution | 1,920 x 1,080 (FHD) |
| | Brightness | 700cd/m ² |
| | Contrast Ratio | 500,000:1 |
| | Viewing Angle (H x V) | 178 x 178 |
| | Surface Treatment | Hard coating (3H), Anti-reflection treatment of the front polarizer (Reflectance < 2%) |
| | Guaranteed Operating Hour | 24 Hours |
| | Orientation | Portrait & Landscape |
| CONNECTIVITY | Input | HDMI, DP, DVI-D, OPS, Audio, USB 2.0, USB3.0, RGB |
| | Output | DP, Audio |
| | External Control | RS232C, RJ45, IR Receiver |
| PHYSICAL SPECIFICATION | Bezel Color | - |
| | Bezel Width | 0.9mm (T/B/L/R) |
| | Monitor Dimension (W x H x D) | 1,211.4 x 682.2 x 86.5mm |
| | Weight (Head) | 18.6kg |
| | Carton Dimensions (W x H x D) | 1,353 x 855 x 263mm |
| | Packed Weight | 25.3kg |
| VESA™ Standard Mount Interface | 600 x 400mm | |
| SPECIAL FEATURES | Temperature Sensor, Tile Mode (up to 15x15), Natural Mode@Tile Mode, Energy Saving, Smart Energy Saving, File Play with USB, Internal Memory, Wi-Fi Dongle Ready, USB Cloning, Content Scheduling, Fail Over | |
| ENVIRONMENTAL CONDITIONS | Operating Temperature Range | 0 °C to 40 °C |
| | Operating Humidity Range | 10 % to 90 % |
| POWER | Power Supply | 100-240V~, 50/60Hz |
| | Power Type | Built-In Power |
| POWER CONSUMPTION | Typ. | 220W |
| | Smart Energy Saving | 110W |
| STANDARD (CERTIFICATION) | Safety | UL / cUL / CB / TUV / KC |
| | EMC | FCC Class "A" / CE / KCC |
| | ErP / Energy Star | Yes / Yes (Energy Star 6.0) |
| MEDIA PLAYER COMPATIBILITY | OPS Type Compatible | Yes |
| | ExternalMediaPlayerAttachable | Yes (MP500/MP700) |
| SOFTWARE COMPATIBILITY | SuperSign-W/Lite | Yes |
| | SuperSign-C | Yes |
| ACCESSORY | Basic | Remote Controller, Power Cable, DP Cable, Manual, IR Receiver, RS-232C Cable, LAN Cable, Guide Bracket, Screw |
| | Optional | OPS Kit (KT-OPSA), HDBaseT (EB-B100) |

Connectivity

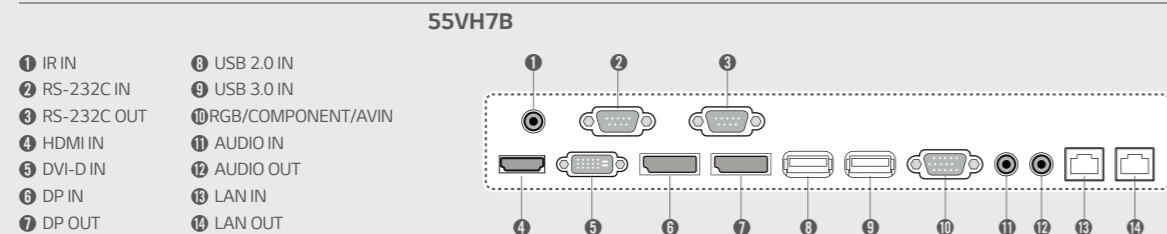

Download LG Commercial Display Mobile App

Artistic Immersion, Overwhelming Attractiveness

World's Narrowest Bezel Video Wall 55VH7B



With its borderless design, the VH7B series offers maximum immersion for video walls. Its quad-core SoC plays various types of content without the need for an extra media player due to its efficient management tools. The VH7B effectively raises customer awareness, particularly in areas with heavy foot traffic such as museums, galleries, and large retail stores.

Key Features

Borderless Design



Narrowest Bezel

Borderless design with its 0.9mm even panel bezel* enables immersive and seamless viewing experiences on assembled video wall screens.

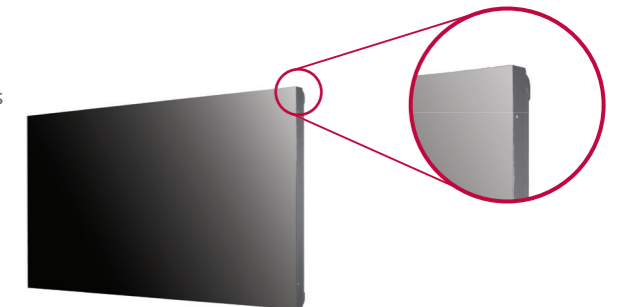

*Panel Bezel :
The black matrix section where an image is not displayed on the front panel.

Smart Platform



Built-in SoC* and Synced Playback

The optimized built-in quad-core SoC in the VH7B can play various content formats and eliminates the need for an external media player. Using its built-in SoC, each display plays its video tile without lag for synchronized content playback.



*System-on-Chip

- CPU**
1.2GHz Quad Core CPU
- Memory**
2.5GB double data 3 (DDR3) 32bit memory
- GPU**
550MHz video processor with full codec (WMV, MP4, HEVC, VP9, and H.264 capabilities)
- Internal Memory**
A storage of 8GB (4GB is occupied by system)

webOS 2.0

The webOS 2.0 platform provides easy and convenient tools to create contents. LG's SDK* and technical supports make content development and management easier.



<http://developer.lge.com/webOSSignage>

*Software Development Kit

Artistic Immersion, Overwhelming Attractiveness

World's Narrowest Bezel Video Wall 55VH7B



Screen Size
55"

55VH7B

- Brightness : 700cd/m²
- Bezel : 0.9mm (T/B/L/R)
- Depth : 87mm
- Interface : HDMI / DVI / RGB / IR, Daisy-chain (DP, RS232C, RJ45)



Key Features

Superior Picture Quality

Clear Viewing Angle

The VH7B ensures clear picture quality even when installed in stacks of more than four. This is very favorable for the quantity of video walls installed in large spaces.

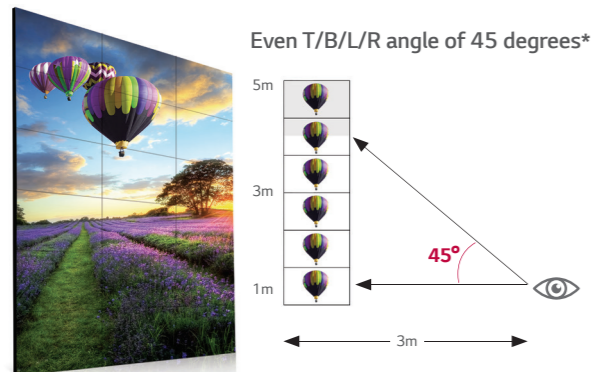

*The angle from the center of the screen to have 50% of the initial luminance.

Uniform Brightness

LG's LED backlight technology guarantees high uniformity in brightness to ensure a clear picture. On other screens, certain spots may appear darker than others, but the new VH7B generates high visibility and a consistent brightness across the whole screen.



Image Gap Reduction

The VH7B includes an image improvement algorithm that can adjust to objects located in the boundary of bezel for a seamless viewing experience.

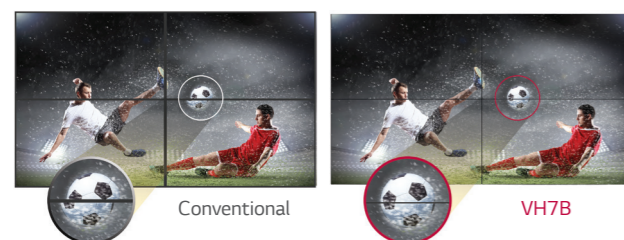

Shine Out

The VH7B is the perfect fit for window displays because it reflects sunlight for better visibility and a clearer image than conventional panels.

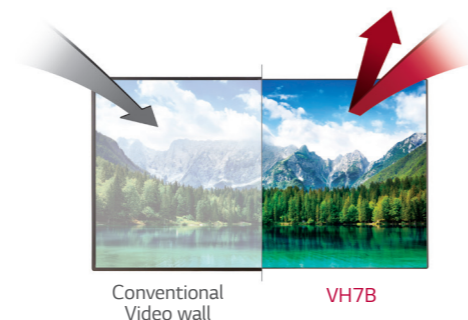

Enhanced Content Management

LAN Daisy Chain Performance

ALAN daisy chain allows you to execute commands to control and monitor the screens and even update their firmware.

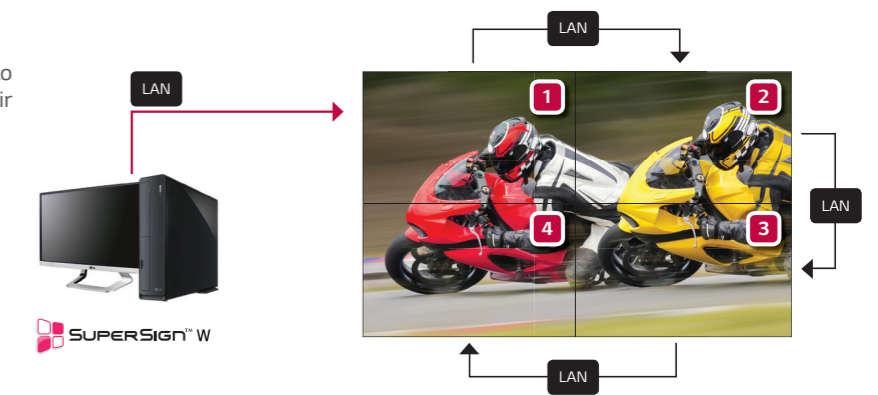

Convenient Options

Guide Bracket / Classified Port

A guide bracket is an attachment that ensures the video wall remains flat. The classified in/out port prevents errors when connecting a daisy chain.

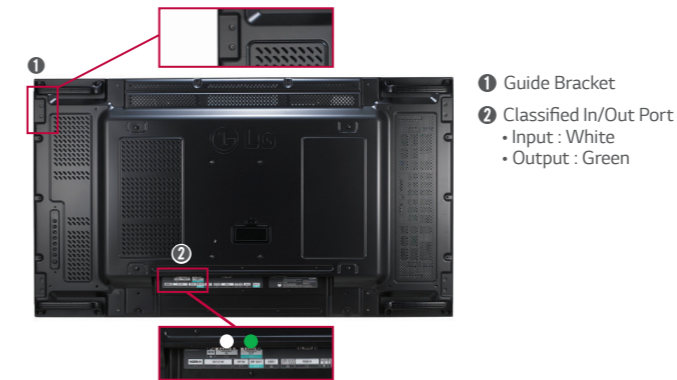

Control Buttons

With 8 control buttons, it's easy to operate various functions of the VH7B, such as controlling the OSD (On Screen Display) and changing the input source.



Dimension (unit : mm)

55"

1,211.4 x 682.2 x 86.5 /
18.6kg

