

SINGLE SPLIT KEY FEATURES

CONSOLE

Healthier Air



Advanced Pre Filter :

The antibacterial pre-filter primarily reduces large dust particles, mould and quit dust.



Plasma Ion Generator :

The sterilised ion generator emits around 1.2 million ions, and traps some of the airborne hazardous substances.

Easy Installation and Service

6 Different Ways to Install Piping

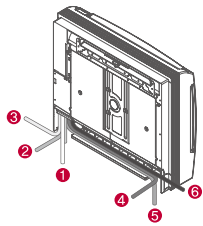

Easy Slide-type PCB

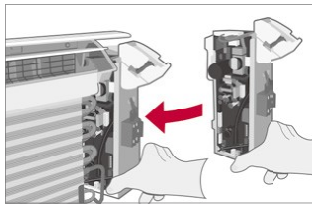

SINGLE SPLIT SPECIFICATION

CONSOLE

STANDARD INVERTER

CQ09
CQ12
CQ18



LG participates in the ECP programme for EUROVENT AC program.
Check ongoing validity of certification.
www.lgairwv-certification.com

UU09W
UU12W

UU18W



		INDOOR	CQ09 NAO	CQ12 NAO	CQ18 NAO
Capacity	Cooling	Min / Norm / Max	1.3 / 2.6 / 3.4	1.4 / 2.5 / 3.7	2.2 / 5.0 / 5.6
	Heating	Min / Norm / Max	1.4 / 2.1 / 4.2	1.6 / 4.0 / 5.4	2.2 / 4.8 / 5.8
Low Temperature Capacity	Heating -7°C	Max	3.4	3.6	4.9
	Heating	Norm	0.64	1.06	1.55
Power Input (Set)	Cooling	Norm	0.74	1.08	1.50
	Heating	Norm	2.0	3.1	4.0
Power Input (Indoor)	Cooling	Norm	3.42 / 3.87	5.02 / 5.03	7.0 / 6.9
	Heating	Norm	1 / 220-240 / 50	1 / 220-240 / 50	1 / 220-240 / 50
Power Supply	Ø / V / Hz		3.98	3.30	3.23
			4.98	3.70	3.20
EER			5.11	5.31	6.2
			3.81	3.81	3.81
COP			3.8	3.0	3.8
			3.74	3.74	A++/A
SEER			172 / 1,032	231 / 1,105	282 / 1,396
			0.635 (1/4)	0.635 (1/4)	0.635 (1/4)
SCOP			0.952 (3/8)	0.952 (3/8)	0.952 (3/8)
			215 / 1,650	215 / 1,650	215 / 1,650
Piping Connection	Gas	mm (inch)	09.52 (3/8)	09.52 (3/8)	0.12 / 1 (1/2)
	Liquid	mm (inch)	6.35 (1/4)	6.35 (1/4)	6.35 (1/4)
Air Flow Rate	High / Medium / Low	m ³ /min	8.5 / 6.7 / 5.0	9.0 / 6.9 / 5.2	10.1 / 8.6 / 7.2
	Sound Pressure	High / Medium / Low	38 / 32 / 27	39 / 32 / 27	44 / 39 / 35
Sound Power	Cooling	Max	53	56	60
	Heating	Max	53	56	60
Dehumidification Rate		l/h	1.2	1.4	2.3
			1.4	1.4	2.3
Dimensions	Body	W x H x D	700 x 600 x 210	700 x 600 x 210	700 x 600 x 210
	Body	kg	14.0	14.0	14.0

		INDOOR	UU09W ULD	UU12W ULD	UU18W UE4
Compressor	Type	Rotary	Rotary	Rotary	Two Rotary
	Airflow Rate	Norm	m ³ /min	32	32
Sound Pressure	Cooling	Norm	47	47	47
	Heating	Norm	48	48	52
Sound Power	Cooling	Max	48	48	52
	Heating	Max	56	57	63
Dimensions	W x H x D	mm	770 x 540 x 245	770 x 540 x 245	870 x 655 x 320
	Net Weight	kg	32.0	33.0	44.6
Refrigerant	Type		R410A	R410A	R410A
	Charge	g	1,000	1,000	1,300
Additional Charge	g/m		20	20	20
	g/m ³		2,087.5	2,087.5	2,087.5
Operation Range (Outdoor)	COOLING		-2.1	-2.1	2.7
	Heating	Min - Max	-10 - 43	-10 - 43	-15 - 48
Power Supply	Ø / V / Hz		-18 - 18	-18 - 18	-18 - 18
			1 / 220-240 / 50	1 / 220-240 / 50	1 / 220-240 / 50
Power Supply Cable	Norm		3C x 2.5	3C x 2.5	3C x 2.5
	Max		4C x 0.75	4C x 0.75	4C x 0.75
Transmission Cable	Norm		15	15	20
	Max		10	10	30
Circuit Breaker	Min - Max		5 - 15	5 - 15	5 - 30
			10	10	30
Piping Length Initial	Min - Max		0.635 (1/4)	0.635 (1/4)	0.635 (1/4)
			0.952 (3/8)	0.952 (3/8)	0.952 (3/8)
Piping Slope Difference	Liquid	mm (inch)	0.635 (1/4)	0.635 (1/4)	0.635 (1/4)
	Gas	mm (inch)	0.952 (3/8)	0.952 (3/8)	0.952 (3/8)

Note: 1. Due to our policy of innovation some specifications may be changed without notification.

2. Definition of Power Input: Nominal conditions - Performance tested under EN14511

3. Capacities are based on the following conditions:

Cooling - Indoor Temperature 27°C DB / 19°C WB - Outdoor Temperature 35°C DB / 24°C WB Heating - Indoor Temperature 20°C DB / 15°C WB - Outdoor Temperature 7°C DB / 6°C WB

4. Annual energy consumption: based on average use of 350 running hours in cooling and 1,400 hours in heating per year at seasonal condition

5. This product contains fluorinated greenhouse gases (R410A)