

42" CLASS (42.0" MEASURED DIAGONALLY)

42LD6DDH

LCD TV

Hospital Grade LCD Widescreen

HDTV with HD-PPV Capability



DESIGNED SPECIFICALLY FOR THE HEALTHCARE INDUSTRY

UL HOSPITAL GRADE LISTED
Built-in Pillow Speaker Port
Built-in Card Slot (MPI™ Interface)
Rear Speaker Disable Switch

EXPANDED PILLOW SPEAKER COMPATIBILITY
Supports multiple codes (Zenith, Philips, RCA)

BED 1 / BED 2 CONTROL
(with optional IR patient remote 124-213-08, sold separately)

EXPRESS SCRIPT
Easy to use, 7 Step Installer
Menu Setup Wizard

MPEG-2/MPEG-4 H.264 DECODING

SPLASH IMAGE LOGO (ON STARTUP)

CLEAR VOICE II

DYNAMIC POWER SAVINGS

USB CLONING - COMMERCIAL SETTINGS

HD VOD PPV DECRYPTION AND
INTERACTIVE SYSTEM CAPABILITY
Integrated Pro:Idiom®

DIGITAL HD-PPV COMPATIBILITY

BUILT-IN ATSC/NTSC/CLEAR QAM TUNER

NATIVE DISPLAY RESOLUTION
1920 x 1080 (Full HD 1080p)

DYNAMIC CONTRAST RATIO
50,000:1

STANDARD VESA™ MOUNTING INTERFACE
200mm x 200mm



CALIFORNIA ENERGY COMMISSION (CEC) COMPLIANT



RESTRICTION OF HAZARDOUS SUBSTANCES (RoHS) COMPLIANT

2 YEAR LIMITED WARRANTY
(parts and labor)

**ENERGY
GUIDE**

The estimated annual energy cost determined in accordance with 16 CFR Part 305.5 for model 42LD6DDH is \$23.

"Your energy cost depends on your utility rates and use. The estimated cost is based on 11 cents per kWh and 5 hours of use per day. For more information, visit www.ftc.gov/energy."¹

¹ FTC Television labeling rule (18 CFR Part 305, as added by 76 Fed. Reg. 1038 (Jan 6, 2011)).

LGsolutions.com



LG

Life's Good



LIFE'S GOOD...

WHEN IT'S GREEN.

LG is committed to improving product development, manufacturing and usage to meet the demand for environmentally friendlier products. Our LD6DDH television has technologies to reduce power consumption and in return increase **cost savings** per room.

EcoSmart

- **Dynamic Power Savings** - Using built-in algorithms, the TV will automatically reduce the power consumption based on incoming video, while maximizing picture performance.
- **Static Power Savings** - Picture brightness level can be set at the preferred power consumption level to reduce power and increase energy savings.
- **CEC Compliant** - Meets the Appliance Efficiency Regulations of the California Energy Commission.
- **RoHS Compliant** - Meets directive on restriction of hazardous substances.
- **Power Management** - Automatic shutoff when TV has no activity after selected 1 - 7 hours of operation.

SPECIAL FEATURES

EXPRESS SCRIPT

EXPRESS SCRIPT INSTALLER MENU WIZARD

The Express Script Installer Menu Wizard enables users to customize essential items for viewing the TV the first time it is turned on. This 7 step process is a convenient and easy way to provide the preferred settings recommended by the facility. The Express Script Installer Menu Wizard can also be activated from the commercial installer menu.

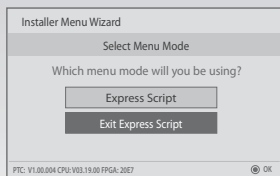

CLEAR VOICE II

BALANCED SOUND TO EMPHASIZE DIALOGUE

Clear Voice technology automatically enhances dialogue when background sounds such as those in an action sequence swell. Enhancements made to the Clear Voice technology now allow users to customize their personal preferences based on their home environment through a 12-step adjustment process. This calibration process is based on distinct voice zoom levels so as to minimize interference with surrounding sounds.



INFINITE SOUND TECHNOLOGY

Infinite Sound is a patented LG technology that addresses the problem of playing 5.1 multichannel content over two speakers.

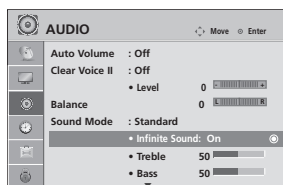

Pro:Idiom®

DIGITAL RIGHTS MANAGEMENT SYSTEM

The Pro:Idiom® system's high-quality security unlocks access to premium content availability to help assure rapid, broad deployment of HDTV and other high value digital content. Pro:Idiom has been designed specifically for industries that use premium HDTV content from cable, satellite or video on demand (VOD) services and as such, could result in lower costs, and reduced maintenance. This system is one of the leading DRM systems embraced by content providers for both of these key programming sources. By using this embedded approach, security is provided and helps eliminate the possibility of customers tampering with or removing needed components.

**To view and to ensure proper operation of Pro:Idiom channels, additional equipment and programming services may be required.*

MPEG-4 TECHNOLOGY (Moving Picture Experts Group)

MPEG-4 decodes and delivers high-definition programming it receives via satellite. The advanced coding system is compatible with national and local HD channels, along with digital HD channels currently launched by DIRECTV. LG built this technology into its LD6DDH TV to deliver pure HD without the need for an external box*.

** Certain functions, such as Pay-Per-View, may require a set-top box.*

POWER SAVING LEVELS

By selecting lower levels of backlight settings, a reduction in power consumption is achieved resulting in energy savings and lower costs.

42LD6DDH in Vivid Mode

BACKLIGHT SETTING VALUE	BRIGHTNESS (cd / m ²)	* POWER CONSUMPTION (Watts)
Level 100	232 cd/m ²	113.8 Watts
90	95%**	96%**
80	92%	94%
70	86%	89%
60	81%	86%
50	75%	82%
40	69%	77%
30	63%	74%
20	53%	66%
10	40%	57%
1	31%	51%

** Power consumption was measured using IEC62087 dynamic broadcast - content video signal*

*** All percentages listed are percentages based off of level 100*

XD[®] ENGINE

SHARPER
BRIGHTER
CLEARER



Dramatization



Dramatization

Six distinct processes contribute to picture improvement. LG's XD Engine takes the low resolution of analog signals to near HD levels by improving brightness, contrast, detail and enhancing color as well as reducing signal noise.

CLONING OPTIONS

The 42LD6DDH has a convenient time and expense saver feature. A select number of commercial menu items are cloning capable. This allows the cloning of a master TV to an infinite number of the same model target TV. This can be easily accomplished in either of two ways, by using a USB memory device or by using an optional LG accessory TLL-1100A TVLink-Loader. This time saving technique will allow the installers to program the preferred commercial settings from a master TV to all the required target televisions in a hospital facility in a matter of just a few minutes per TV.

Clone using a USB Memory Device

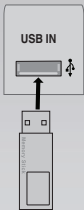

The Installer sets up a master TV with the preferred menu settings. A USB memory device is plugged into the master TV. Menu items are selected to "Learn From TV" and stored on the USB memory device. The USB stick is then plugged into a target TV. Menu items are selected to "Teach To TV". The USB device is then unplugged and is ready to engage with the next target TV.

OR

Clone using OPTIONAL TLL-1100A TVLink-Loader



The Installer sets up a master TV with the preferred menu settings. The TLL-1100A TVLink-Loader is charged up and the MPI cable is connected to both the TLL-1100A and the Master TV. By selecting buttons on this TVLink-Loader, menu items are selected to "Learn From TV" and stored on the TLL-1100A (about 90 seconds). The TLL-1100A is then plugged into a target TV. By selecting buttons on the TVLink-Loader, the TLL-1100A menu items are selected to "Teach To TV". The TVLink-Loader is then unplugged and is ready to engage with the next target TV.

DIMENSIONS

42LD6DDH

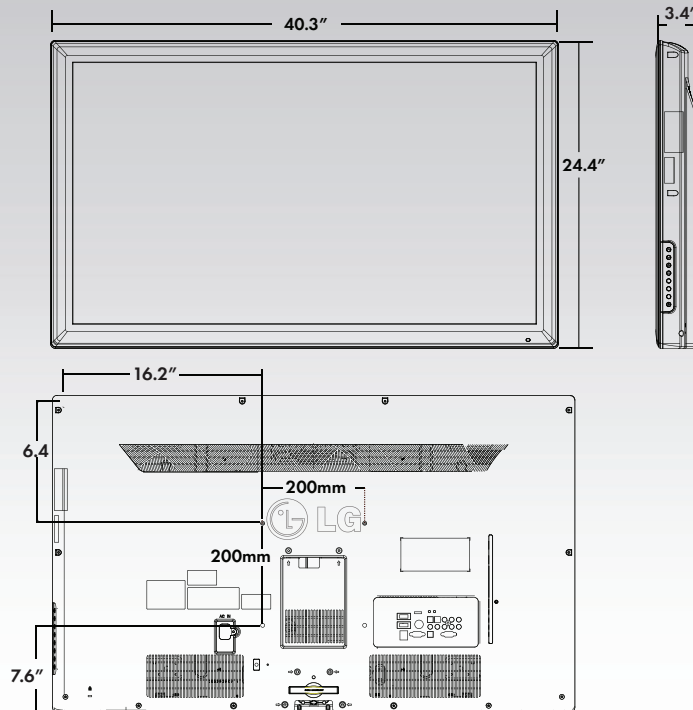

OPTIONAL ACCESSORY REMOTES

INSTALLER REMOTE 124-213-07

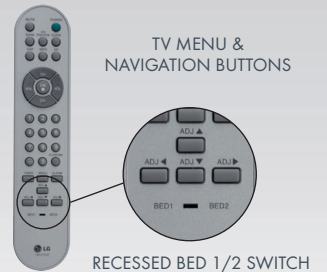

PATIENT BED 1/2 REMOTE 124-213-08

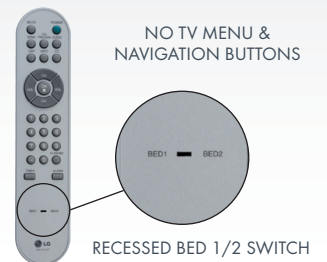

42LD6DDH
REAR

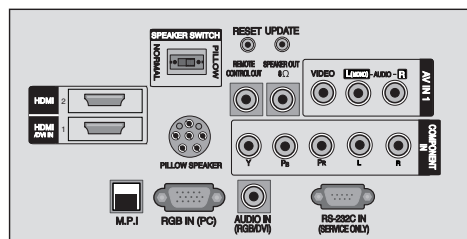

SIDE



PILLOW SPEAKER ACCESS

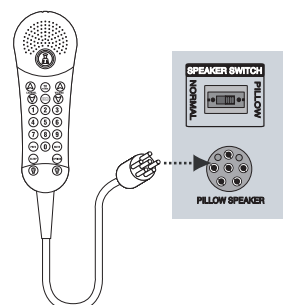

42LD6DDH

42" CLASS (42.0" MEASURED DIAGONALLY)

SPECIFICATIONS

DISPLAY

LCD Panel Type	42" class
Display Area	42.0" diagonal
Aspect Ratio	16:9
Native Resolution	1920 x 1080
Dynamic Contrast Ratio	50,000:1
Contrast Ratio	800:1
Viewing Angle (Horizontal/Vertical)	178°/178°
Lamp Life	50,000 hours (approx.)
Response Time	5ms

MAIN SYSTEM

MPEG2/MPEG4/H.264 Decoding	Yes
Maximum Computer Resolution (RGB)	1920 x 1080

TUNING SYSTEM

# of Tuners	1
ATSC/NTSC/QAM	Yes

VIDEO

Comb Filter	Yes
Digital Progressive Scan	Yes
Color Temperature	Warm/Medium/Cool
Enhanced Video	Yes (Dynamic Color, Noise Reduction, Gamma, Black Level, Eye Care, Real Cinema, Color Gamut, Edge Enhancer)

DLTI (Digital Luminance Transient Limiter)	Yes
DCTI (Digital Color Transient Improver)	Yes
Black/Blue Stretcher	Yes
3:2 Pull-Down (film mode)	Yes
Aspect Ratio	Yes (16:9/Just Scan/Set By Program/4:3/Zoom)
XD Color (Active Color Management)	Yes
XD Engine	Yes
Picture Status Modes	6 Modes (Vivid/Standard/Natural/Cinema/Sport/Game)

AUDIO

Dolby Digital® Decoder	Yes
Mono/Stereo/SAP	Yes
LG's patented Infinite Sound	Yes
Invisible Speaker System	Yes
Clear Voice II	Yes
Total Audio Watts (RMS)	2 x 10W (20W)
Bass/Treble/Balance	Yes
Auto Volume Leveler	Yes
Sound Modes	5 Modes (Standard, Music, Cinema, Sport, Game)
Internal Speaker On/Off	Yes
Audio Language (in DTV mode)	English/Spanish/French

JACKS

RF In	1
A/V In	2 (1 Rear/1 Side)
Component & R/L Audio In	1 (Rear)
RGB In (DB15-RGB)	1 (Rear)
Audio in (RGB/DVI)	1 1/8" phone jack (Rear)
HDMI	2 (Rear)
Speaker Out	1W fixed (phone jack)
RS-232C (service only)	1 (Rear)
IR In/Out	IR out (Rear)
Earphone Jack	1 (Side)
Pillow Speaker Port	1 (Rear)
USB (cloning/service only)	1 (Side)
MPI Slot	1 (Rear)

CLONING

USB Cloning	Yes
TLL-1100A TVLinkLoader	Yes (Optional, sold separately)

SPECIAL FEATURES

Power Saving Function	Backlight dimming control
Integrated Pro:Idiom*	Yes
Express Script (Easy, 7-step setup)	Yes
Expanded Pillow Speaker Compatibility	Yes (Supports multiple codes: Zenith, Philips, RCA)
Splash Image Logo (on startup)	Yes
Commercial Installation Menu	Yes
TV Link Protocol	Yes
Discrete IR Codes	Yes
Last Source Power-on Recall	Yes
Auto/Manual Clock	Yes
Auto On/Off Time Setting	Yes
Sleep Timer	Yes
Menu Language	English/Spanish/French/Korean
Auto/Manual Programming	Yes
Auto Shut-Off Setting	Yes
Channel Labeling	Yes
Closed Caption	Yes (8 options)
Mute	Yes
Flashback (Quick View)	Yes
Parental Control/V-Chip	Yes
Function Menu	Yes

AGENCY APPROVALS

UL, C-UL, NOM	Yes
RoHS Compliant	Yes
CEC Compliant	Yes
UL Hospital Grade	Yes

CABINET

Color	Matte Black
Unit Dimensions (WxHxD)	40.3" x 24.4" x 3.4"
Unit Weight	33.3 lbs
Shipping Dimensions (WxHxD)	43.6" x 30.3" x 9.0"
Shipping Weight	48.1 lbs
Kensington Security Slot	Yes
VESA™ Standard Mount Interface	200mm x 200mm, M6 screws
Stand	Not included

INCLUDED WITH TV

UL Hospital Grade Power Cord	6 ft. (right angle wall plug)
Owner's Manual	Yes (printed & CD)
Protection Cover	Yes (covers stand opening)
Commercial Mode Setup Guide	Yes
Cable Management Clip	Yes

OPTIONAL ACCESSORIES

TVLink-Loader Cloner	TLL-1100A
Patient Remote with Bed 1/Bed 2	124-213-08
Installer Remote	124-213-07

POWER

Dynamic/Static Power Savings	Yes
Power Source	110V
Power Consumption (max.) with Power Saving Modes Disabled	140W
Power Stand-by Mode (max.)	1W
Power Consumption (typ.)	100W

OPERATING ENVIRONMENTS

Storage Temperature Range	-4° ~ 140°F
Storage Humidity Range	Less than 85%
Operating Temperature Range	32° ~ 104°F
Operating Humidity Range	Less than 80%

SERVICE/LIMITED WARRANTY

UPC CODE	
42LD6DDH	7 19192 90235 0

*To view and to ensure proper operation of Pro:Idiom channels, additional equipment and programming services may be required.



All screen images are simulated. Dimensions and weights are approximate. Design, features and specifications subject to change without notice.

© Copyright 2011 LG Electronics USA, Inc. All Rights Reserved. "LG Life's Good" is a registered trademark of LG Corp. XD Engine is a registered trademark of LG Electronics USA, Inc. Pro:Idiom is a registered trademark and MPI is a trademark of Zenith Electronics Corp. Dolby and the double-D symbol are registered trademarks of Dolby Laboratories. SRS and the SRS symbol are registered trademarks of SRS Labs, Inc. in the U.S. and selected foreign countries. TruSurround XT is a trademark of SRS Labs, Inc. VESA is a trademark of Video Electronics Standards Association. All other product and brand names are trademarks or registered trademarks of their respective companies.

Printed in the USA. September 2011

LGsolutions.com

LG Electronics U.S.A., Inc.
Commercial Displays
2000 Millbrook Drive
Lincolnshire, IL 60069

Contact your LG Regional Sales Representative
Healthcare: 877.793.6484

Customer Service: 888.865.3026

SPEC_42LD6DDH_051104_PR



LG
Life's Good