

# 4K UHD Hospital Grade Pro:Centric SMART with Integrated Pro:Idiom® and b-LAN™ - UV770M



HEALTHCARE

## ▶ 55UV770M

55" class (54.8" diag)

## ▶ 49UV770M

49" class (48.5" diag)

## ▶ 43UV770M

43" class (42.5" diag)

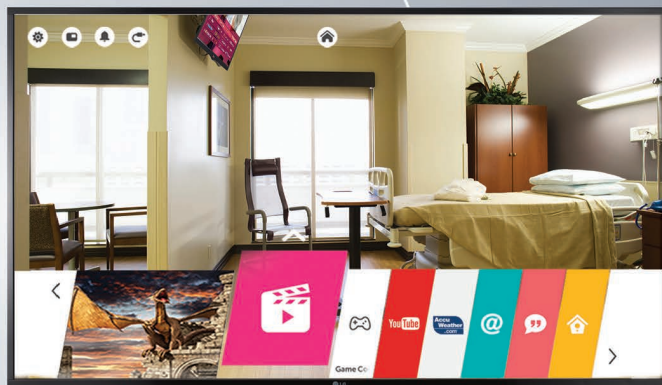

## SAFE AND CONVENIENT FOR ALL USERS

### HOSPITAL SAFETY STANDARD COMPLIANT



### CONVENIENT FOR PATIENTS AND HOSPITAL STAFF



Nurse Call System



Pillow Speaker



Easily share and enjoy content from your laptop, smartphones, digital cameras and other compatible devices seamlessly to the TV\*.

\*Video playback only - content on phones can play on the TV through the Smart Share app on compatible LG smartphones.



Wi-Fi



WiDi



Miracast



Similar to a smartphone, LG's Pro:Centric Smart TVs have Wi-Fi built-in, allowing easy connectivity and access to and from the TV.



## PRODUCT HIGHLIGHTS

4K ULTRA HD Resolution

Designed Specifically for the Healthcare Industry

UL Hospital Grade Listed

RoHS Compliant

California Energy Commission (CEC) Compliant

Built-in Pillow Speaker Port

Built-in MPI Port

TV Speaker Disable

Built-in Pillow Speaker Compatibility

Supports multiple codes (Zenith, Philips, RCA)

First Use Wizard

LG's Exclusive Pro:Centric Application Platform

Supports Java™ and Adobe® Flash® Applications  
(Pro:Centric Dual Tuner)

Remote Management of Television

Using Pro:Centric server

Dynamic/Static Power Savings

Multi IR Code Support

Integrated Pro:Idiom® Digital Rights Management Technology

Splash Screen Image/Logo (On Startup)

Customized Welcome Screen  
(Pro:Centric application feature)

MPEG-2 / MPEG-4 H.264 Decoding

USB Cloning

On-site 2 Year Limited Warranty (parts and labor)

TV Stand: Not Included

# Pro:Idiom®

## GLOBAL LEADING DIGITAL RIGHTS MANAGEMENT SYSTEM

Pro:Idiom unlocks access to premium content to help assure rapid and broad deployment of HDTV and other digital content.

Pro:Idiom has been designed specifically for users of premium HDTV content from cable, satellite, or video on demand (VOD) services, and is thus designed to lower costs and reduce maintenance needs. This leading DRM system is embraced for its security solution, which prevents illegal copying of copyrighted content.

## REDUCED TOTAL COST OF OWNERSHIP



The EZ-Manager's auto configuration function makes installation quick and easy. The EZ-Manager guides the installer to set up the TV with simple steps, helping to save time.

## EXPRESS SCRIPT

The Express Script provides streamlined configuration of the TV for Free-To-Guest (FTG) Mode via CPU operation (including pillow speaker setup) and also provides the option to configure the TV for Pro:Centric operation.



Using LG's optional Pro:Centric server, you can remotely manage configuration and channel mapping for TVs in patient rooms without having to visit each room.

# Pro:Centric®

## PRO:CENTRIC APPLICATION PLATFORM

**Interactive Patient Room Experience**  
An industry leading television that supports the Pro:Centric platform, LG's new UV770M allows healthcare facilities to customize the patient room experience. The Pro:Centric application allows you to create your own content and manage multiple channels, which can be specialized for your hospital. Pro:Centric also provides an easy way for the UV770M to interface with interactive program guides, games and internet data feeds, as well as applications designed to connect patients to services, such as dietary menus and patient room information.\*



\* May require additional software and hardware to support third-party partner interactive systems or LG's Free-To-Guest Mode/Pro:Centric application.

## THE UV770M PRO:CENTRIC APPLICATION PLATFORM

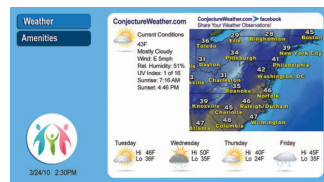

## LG'S FREE-TO-GUEST SOLUTION

When these TVs are configured for LG's Free-To-Guest Mode of operation (either via CPU or EBL), remote management options are available, as described below. With remote management, individual room visits are no longer required for TV configuration updates, including FTG Channel Map and FTG Installer Menu settings updates.

## FREE-TO-GUEST REMOTE MANAGEMENT HEAD END DEVICES

### PRO:CENTRIC SERVER

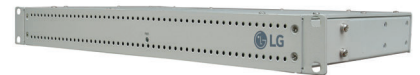

Remote management of the FTG Channel Map and FTG Installer Menu settings may be provided by a Pro:Centric server. The Pro:Centric server Admin Client web editor/content wizard also enables users to remotely update the Pro:Centric application features.

## FREE-TO-GUEST MANAGEMENT APPLIANCE

LG's Free-To-Guest Management Appliance (FMA) delivers the FTG Channel Map to the patient rooms, via the hospital's RF distribution.



## CLONING USING A USB MEMORY DEVICE



The UV770M Healthcare TV has a convenient time and expense saver feature. Installer Menu settings, along with a select number of setup menu features are cloning capable, and an FTG Channel Map may also be cloned.

Cloning typically refers to the process of using a Master TV Setup to configure a Target TV. The installer sets up the Master TV with preferred menu settings, and then saves (exports) the settings to a file on the USB memory device. This file may then be transferred (imported) to the Target TV(s) via the same USB device.

This time saving technique will allow the installers to configure each UV770M TV in the hospital facility in a matter of just a few minutes per TV.

LG is committed to improving product development, manufacturing and usage to meet the demand for products with environmentally friendly features. Our televisions have technologies to help reduce power consumption and can increase cost savings per room.

#### SMART TECHNOLOGY

**Dynamic Power Savings** - Using built-in algorithms, TV will automatically reduce the power consumption based on incoming video, while maximizing picture performance.

**Static Power Savings** - Picture brightness level can be set at the preferred power consumption level to reduce power and help increase energy savings.

#### COMPLIANCE

**CEC Compliant** - Meets the Appliance Efficiency Regulations of the California Energy Commission.

**RoHS Compliant** - Meets directive on restriction of hazardous substances.

#### 55UV770M

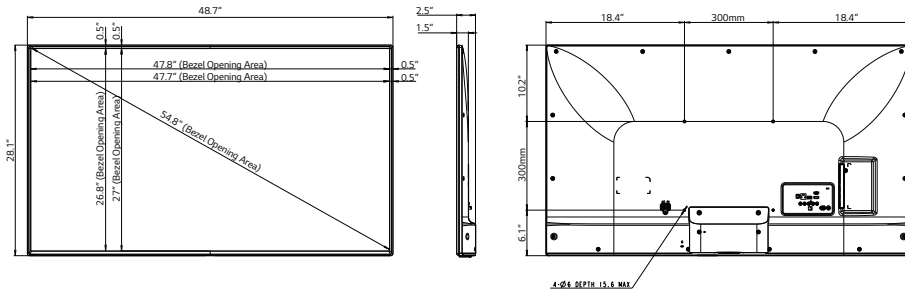

#### 49UV770M

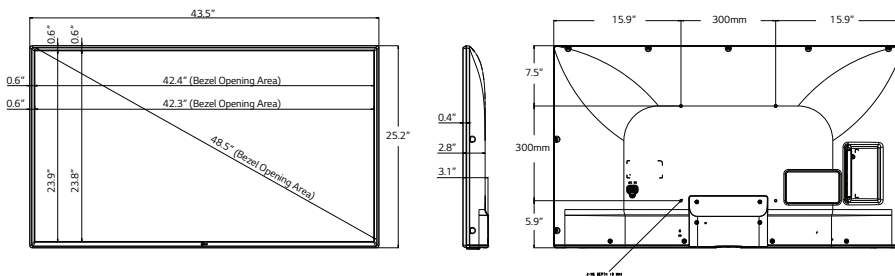

#### 43UV770M

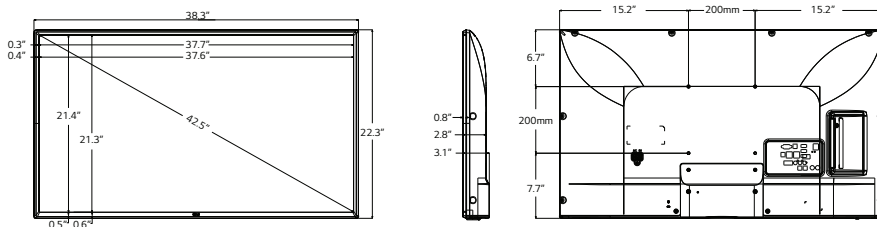

#### Rear Jack Panel

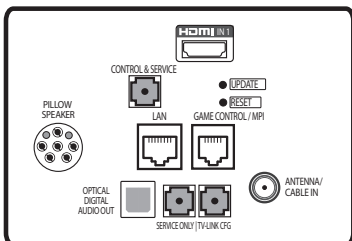

#### Side Jack Panel

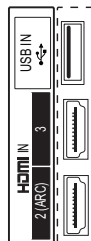

#### OPTIONAL ACCESSORY REMOTES

##### INSTALLER REMOTE INSTALLERRC



##### PATIENT MULTI-BED REMOTE PATIENTRC



##### PRO:CENTRIC PILLOW SPEAKER



# 4K UHD Hospital Grade Pro:Centric SMART

## with Integrated Pro:Idiom and b-LAN™ - UV770M

▶ 55UV770M

55" class (54.8" diag)

▶ 43UV770M

43" class (42.5" diag)

▶ 49UV770M

49" class (48.5" diag)



HEALTHCARE

PANEL	MODEL	55UV770M	49UV770M	43UV770M
	Backlight Type		Edge	
	Resolution		3840 X 2160 (4K UHD)	
	Static (Panel) Contrast Ratio		1200:1	
	Viewing Angle Degree		178x178	
	Response Time (G to G)		8ms	
BROADCASTING SYSTEM	Frame Rate		T120	
	Analog		Yes (NTSC)	
	Digital		Yes (ATSC)	
	Terrestrial		VSB	
VIDEO	Cable		Clear QAM/VSB	
	XD Engine		Yes	
	Real Cinema 24p (3:3 pull down)		Yes	
	Picture Mode		Yes 9 modes (Vivid, Standard, APS(Eco), Cinema, Sports, Game, HDR Effect, Expert(Bright Room), Expert (Dark Room))	
	Aspect Ratio		Yes 6 modes (16:9, Original, 4:3, Vertical Zoom, All-Direction Zoom, Just Scan)	
AUDIO	HDR 10		Yes	
	Audio Output		10W+10W	
	Speaker System		2.0ch	
	Sound Mode		Yes 6 modes (Standard, Cinema, Clear Voice III, Sports, Music, Game)	
	Optical Sound Sync		Yes	
HOSPITALITY SOLUTION	Wireless Sound Sync		Yes	
	Clear Voice		Yes	
	Pro:Centric Smart		Yes	
	Data Streaming (IP & RF)		Yes	
	RF (1/2 Tuner)		Yes (2 Tuner)	
	HCAP (GEM/FLASH/HTML)		GEM / Flash / HTML5	
	IP Return path		Yes	
	Multicast/Unicast ready		Yes	
	webRTC		Yes	
	Pro:Centric Direct		Yes	
SMART FEATURE	Pro:Centric Application		Yes (PCA3.7.5)	
	PCS400R		Yes	
	PCS200S		Yes	
	ProIdiom Software		Yes	
	webOS version		webOS 3.5	
	Commercial Smart Home		Yes	
	Web Browser		Yes	
	Pre-loaded App		Yes	
	SDP Server compatibility		Yes	
	Magic Remote Compatibility		Yes (Optional)	
FUNCTION	Soft AP		Yes	
	WiFi (bandwidth)		Yes (802.11a/b/g/n/ac)	
	Screen Share (Miracast, WiDi)		Yes	
	Smart Share		Yes	
	DIAL		Yes	
	Bluetooth Sound Sync		Yes	
	LG Sound Sync/bluetooth		Yes	
	EZ-Manager		Yes	
	USB Cloning		Yes	
	Wake on RF		Yes	
	WOL		Yes	
	SNMP		Yes	
	Diagnostics		Yes (Remote Diagnosis)	
	SI Compatible (TVLink Interactive)		Yes (MPI protocol)	
	HTNG-CEC		Yes	
	HDMI-CEC		Yes	
	IR Out		Yes (MPI Jack/HDMI)	
	Multi IR Code		Yes	
	Installer Menu		Yes	
	Welcome Screen (Splash Image)		Yes	
	Insert Image (No signal)		Yes (webOS Default)	
	Logical Channel Map		Yes	
	External Speaker Out		Yes	
			(Variable/Fixed/Line Out, 3.5mm, Stereo, Single ended Type(GNDL+R+), 1W with 8Ω)	

FUNCTION	MODEL	55UV770M	49UV770M	43UV770M
	Instant On		Yes	
	RIP Interface		Yes (HDMI)	
	RIP Compatibility		Yes - Teledapt/Guestlink (HDMI CEC)	
	Moving Picture Playback (SD/HD/Plus HD)		asf, wmv, avi, mp4, m4v, mov, 3gp, 3g2, mkv, mpg, mpeg, dat, etc.	
	Picture		jpeg, jpg, jpe, BMP, PNG	
	Audio Codec		mp3, wav, OGG, WMA, flac	
	Auto Off / Sleep Timer		Yes/Yes	
	Smart Energy Saving		Yes	
	Motion Eye Care		Yes	
	b-LAN embedded		Yes	
SIDE	Pillow Speaker		Yes	
	HDMI In		2 (2.0)	
	USB		1 (2.0)	
	RF In		1 (b-LAN)	
REAR	Digital Audio Out		1 (Optical)	
	HDMI/HDCP Input		1 (2.0)	
	RS-232C (D-Sub 9pin)		1 (TV link MNT, Phone jack type)	
	RJ45		1 (Ethernet/SVC/RIP Interface)	
	TV link Configuration (Phone jack type)		1 (b-LAN Service)	
	MPI Port (RJ12 jack)		1	
	Debug (Phone Jack Type)		1 (CPU/PTC Debug)	
	Pillow Speaker interface (6pin)		1	
	DESIGN		Shine Titan	
	VESA Compatible		300mm x 300mm	200mm x 200mm
CABINET	Weight (Packing)	35.3 lbs	24.9 lbs	20.3 lbs
	WxHxD (w/o stand)	48.7" x 28.3" x 1.6" (SPK 2.5")	43.6" x 25.4" x 2.8" (SPK 3.1")	38.3" x 22.5" x 2.8" (SPK 3.1")
	WxHxD (Packing)	53.5"x3.3"x6.0"	47.0"x30.3"x6.2"	41.7"x26.0"x6.0"
	Bezel Width (Left/Right, Upper, Bottom) : on bezel (mm)	8.8/8.8/13.8	10/10/15.2	
	Bezel Width (Left/Right, Upper, Bottom) : Off bezel (mm)	6.8/6.8/11.3	8.5/8.5/13.7	
	POWER		120V, 50/60Hz	
	Voltage, Hz			
	Typical (Watts)	60.3	57.6	49.7
	Based on Energy Star Qualified			
	Stand-by		< 0.5W	
CERTIFICATION	Safety		UL	
	EMC		FCC	
	ETC.		RoHS, UL, NOM, Energy Star 7.0	
ACCESSORIES	Anti-theft Dongle Cover		Yes	
	Power Cable		Yes (5.9ft, Angle Type)	
	Manual / ESG		Yes (Simple Manual)	
OTHER	UPC	7 19192 91999 0	7 19192 91998 3	7 19192 91995 2
	Warranty		2-Year Limited Warranty Parts/Labor	
TECHNOLOGY PARTNERS	SOME INTERACTIVE SYSTEMS MAY REQUIRE AN EXTERNAL DEVICE			



The estimated annual energy cost determined in accordance with 16 CFR Part 305.5 for models 55UV770M, 49UV770M and 43UV770M are \$14, \$13, \$11 respectively.

\*Your energy cost depends on your utility rates and use. The estimated cost is based on 12 cents per kWh and 5 hours of use per day. For more information, visit [www.ftc.gov/energy](http://www.ftc.gov/energy)

\*FTC Television labeling rule (18 CFR Part 305, as added by 76 Fed. Reg. 1038 (Jan 6, 2011)).



All screen images are simulated. Dimensions and weights are approximate. Design, specifications, and features subject to change without notice.

© Copyright 2017 LG Electronics USA, Inc. All Rights Reserved. Pro:Idiom is a registered trademark of Zenith Electronics LLC. Pro:Centric, XD Engine, Smart Share, and the "LG" logo are registered trademarks of LG Electronics Inc.

In Plane Switching is a trademark of LG Display Co., LTD. Java is a trademark of Oracle, Inc. Adobe and Flash are either registered trademarks or trademarks of Adobe Systems Incorporated in the United States and/or other countries. VESA is a trademark of Video Electronics Standards Association. HDMI, the HDMI logo and High-Definition Multimedia Interface are trademarks or registered trademarks of HDMI Licensing LLC. b-LAN is a trademark of SONIFI Solutions, Inc.

All other product and brand names are trademarks or registered trademarks of their respective companies.

[www.LG.com/us/commercial](http://www.LG.com/us/commercial)



LG Electronics U.S.A., Inc.  
HE B2B Division  
2000 Millbrook Drive  
Lincolnshire, IL 60069

Customer Service: 888.865.3026  
[www.LG.com/us/commercial/display-support](http://www.LG.com/us/commercial/display-support)

Contact your LG Regional Sales Representative:  
Channel: 800.897.8871  
Hospitality: 800.228.1236  
E-mail: [info@LGSolutions.com](mailto:info@LGSolutions.com)

SPEC\_UV770M\_111719\_PR