

LG SABER™



QUICK START GUIDE



Sending a
Text Message



Taking and
Sharing Pictures



Bluetooth® Pairing

lgusa.com/saber

Getting to Know Your Phone



FRONT

1. Earpiece
2. LCD Screen
3. Directional Key
^ Favorites
v **easyedge**SM
> My Menu
< Calendar
4. Camera Key
5. Left Soft Key (Message)
6. Send Key
7. Function Key
8. Caps/Shift Key
9. Space Key
10. Lock Key*
11. Speaker/Symbols Key
12. Voice Commands Key
13. Return Key
14. Delete Key

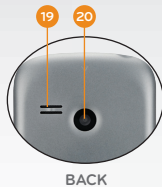

BACK

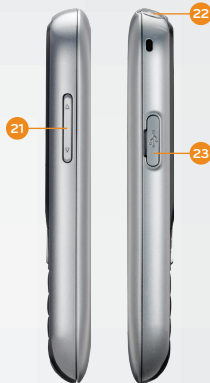

SIDES

15. Power/End Key
16. Right Soft Key (Contacts)
17. Clear & Back Key
18. Menu/OK Key
19. Speaker
20. Camera Lens
21. Volume Up/Down Keys
22. Headset Jack
23. Micro USB Charging Port

*Press and hold to lock or unlock the phone.

Sending a Text Message

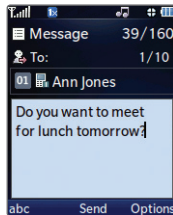
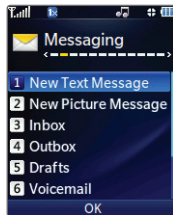

Stay in touch without placing a call with convenient text messaging.

1. From standby mode, press the **Left Soft Key** for **Message**.
2. Select **New Text Message (1)**.
3. Enter a number or press the **Right Soft Key** for **Options** and select **Contacts (1)**. Highlight the contact(s) you wish to add, press **OK** for **Select**, and then press the **Left Soft Key** for **Done**.
4. Press **down** on the **Directional Key** to move to the text field.
5. Enter your text with the QWERTY keyboard and press **OK** for **Send**.



Taking and Sharing Pictures

Capture the moment with Saber's easy-to-use camera.

1. From standby mode, press .
2. Press **left** or **right** on the **Directional Key** or press the **Right Soft Key** for **Options** to access options and settings. If the menus are hidden, press **up** on the **Directional Key** to see them again.
3. When you're ready, press  or **OK** for **Capture** to take the photo.
4. Select **Send (1)**. Your photo will be saved.
5. See the **Sending a Text Message** panel for information on how to address and send the message.

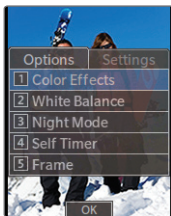

Bluetooth® Pairing

Connect to accessories, computers, and other phones via *Bluetooth* wireless technology.

1. Before you begin, set your *Bluetooth* accessory into pairing mode.*
2. From standby mode, press **OK** for **Menu** and select **Settings (9) > Bluetooth (5)**.
3. Select **Paired Devices (1)**, and then press the **Left Soft Key** for **Search**.
4. If *Bluetooth* power is off, press **OK** to turn it on, and then select **New Search (1)**.
5. Highlight your device and press **OK** for **Pair**.
6. Press **OK** to connect to your device.

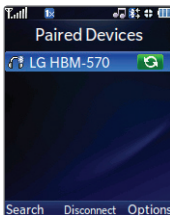
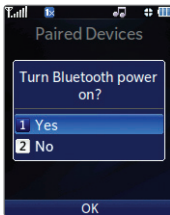

*Refer to your *Bluetooth* accessory's user guide for information about initiating pairing mode and the passcode if asked (typically "0000").

Note: *Bluetooth* accessories sold separately.



Bluetooth Headset
(HBM-235 – Purple and Black)



Bluetooth Headset
(HBM-570 – Silver, Dark Blue,
Pink, and Purple)



*Bluetooth Headset with
Speakerphone/Solar Charging
Cradle* (HBM-810)



Bluetooth Stereo Headset
(HBS-700)



*Bluetooth Headset with Vehicle
Power Charger* (HBM-585)



Vehicle Power Charger



Maximize your phone with these cutting-edge accessories at
lgusa.com/saber

All materials in this guide including, without limitation, the design, the text, and any marks are the property of LG Electronics, Inc. Copyright © 2011 LG Electronics, Inc. ALL RIGHTS RESERVED. Features and specifications are subject to change without prior notice. Saber™ is a trademark of LG Electronics, Inc. The Bluetooth® word mark and logos are registered trademarks owned by Bluetooth SIG, Inc. Other trademarks and trade names are those of their respective owners. Unless otherwise specified herein, all accessories referenced herein are sold separately.



Mixed Sources
Product group that well-managed
forests, controlled sources and
recycled wood or fiber
www.fsc.org Cert no. X000-1000-1000
© 1996 Forest Stewardship Council

