

Edge-lit Smart IPTV with Ultra HD and Integrated b-LAN™

The UV770H is a cost-effective Smart IPTV model series, offering Ultra HD display and an edge-lit LED display with a slim bezel design. This series supports the Pro:Centric® SMART application platform, as well as Media Share features and integrated Pro:Idiom® technology. The UV770H models also have an embedded b-LAN™ module.



UV770H

- Pro:Centric® SMART
- Integrated Pro:Idiom® DRM Technology
- Ultra HD
- webOS & Media Share Features
- Commercial Grade Stand (Except 65UV770H)
- ^{NEW} Dolby Vision™ High Dynamic Range (HDR) with HDR10 Compatibility

screen size

43" (42.7" diagonal), 49" (48.7" diagonal), 55" (54.6" diagonal), 65" (64.8" diagonal)

Key Features

Pro:Centric® SMART

The UV770H is the latest in the line of Pro:Centric TVs that provide a unique and dedicated hotel applications hosting platform for LG's system integrators' interactive applications, enabling delivery for a wide range of custom applications tailored to both hotel management and guests' needs.

LG Pro:Centric SMART offers extended customizable tools: HTML5, Java and Flash. Using these tools, partners can optimize the TVs by editing and developing their own enhanced service design to increase the visual impact on guests.

Pro:Idiom®

GLOBAL LEADING DIGITAL RIGHTS MANAGEMENT (DRM) SOLUTION

Pro:Idiom unlocks access to premium content to help ensure rapid and broad deployment of HDTV and other digital content. Pro:Idiom has been designed specifically for users of premium HDTV content from cable, satellite, or video on demand (VOD) services, and help reduce costs and reduce maintenance. This leading DRM system is embraced for its security solution, which helps prevent illegal downloading of copyrighted content.

Media Share Features

Smart Share

LG Smart Share® allows guests to use the TV to access video, image, and music shared by DLNA Certified® devices connected to the same Access Point as the TV.



Screen Share

Screen Share enables screen sharing with a Miracast® or Wireless Display (WiDi) capable device (e.g., a laptop with Intel® hardware).



Bluetooth Sound Sync (Bluetooth 3.0)

Bluetooth Sound Sync allows guests to listen to audio from a Bluetooth-enabled mobile device through the TV's speakers.

* Support devices for Bluetooth Sound Sync :

Android (above v4.4 KitKat) / iOS based Mobile Device



SoftAP

SoftAP enables the TV to function as a 2.4 GHz wireless access point for up to five devices.



DIAL

DIAL (Discovery and Launch) allows guests to play selected application media on the TV from a device with DIAL capability. The device may be used to cast any application for which a TV-compatible application has been created/selected.



Pre-loaded Apps

Guests can be served with bandwidth-worry-free pre-loaded applications, including Accuweather, Crackle, HULU, Web Browser, and YouTube (other applications may be added in the future, subject to licensing terms).



Edge-lit Smart IPTV with Ultra HD and Integrated b-LAN™

Pro:Centric Application

Personalize the guest room television experience with the Pro:Centric Application (PCA), which provides guests' access to a variety of additional features, such as an interactive Electronic Program Guide (EPG), weather forecast and radar map, and customized electronic billboards for information on hotel amenities, all conveniently presented through the on-screen menus.

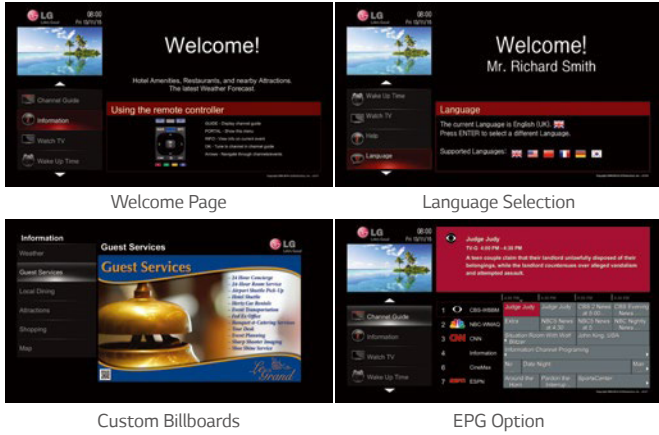

Free Interactive EPG Service for Pro:Centric TVs

PLAN HIGHLIGHTS

If your property has purchased or plans to purchase LG's Pro:Centric TVs, you may qualify for a free EPG that allows guests to easily navigate TV channels and programs, just like they do at home. Participating properties must purchase and install a Pro:Centric server and supply an internet connection for daily program updates. Properties must also contract with an LG authorized partner to install and program the server to match your free-to-guest (FTG) Channel Map.

Free program guide service runs until December 2017, replacing the previous programming fee of \$1.50 per room per month.

Contact your LG sales representative or visit: www.LG.com/us/commercial/display-discover/epg

LG's FTG COST EFFECTIVE SOLUTION

When using LG televisions in FTG hotel installations, the Pro:Centric server (PCS200S) supports remote management of TV settings. With remote management, individual room visits are no longer required for TV configuration updates, including FTG Channel Map and FTG Installer Menu settings updates.

Hotel Costs For FTG Channel Management

	Estimated Labor Costs	MSRP	Total	Potential savings over room visit
LG Pro:Centric TV with Pro:Centric Server		\$2,499 (PCS-200S)	\$2,499	\$17,501
Manual Room Updates	\$20(est.) x 2 times per year (to update channels) x 100 rooms x 5 years		\$20,000	
LG Pro:Idiom TV with embedded b-LAN plus FMA		\$2,900 (FMA-LG102)	\$2,900	\$17,100

MSRP subject to change. Installation not included.

HEAD END SYSTEM

Remote management functions are supported via the Pro:Centric server.



The Pro:Centric Application software can be remotely added at a later date to deliver the benefits of LG's Pro:Centric Application features (Weather, EPG, Billboards, etc.).

Pro:Centric Direct Ready

Simply create your own templates and remotely manage TVs on the IP network with Pro:Centric Direct, LG's content management software. Pro:Centric Direct offers a Project Editor, along with customizable widgets and three types of theme templates (Cinematic-type, Grid-type, Bar-type) in order to promote branding and provide useful information for guests. Its interactive features will impress guests by elevating their in-room experience. Plus, for hoteliers, not only does it offer efficient content production and management, it also maximizes advertisement effectiveness, which contributes to improving the hotel brand.

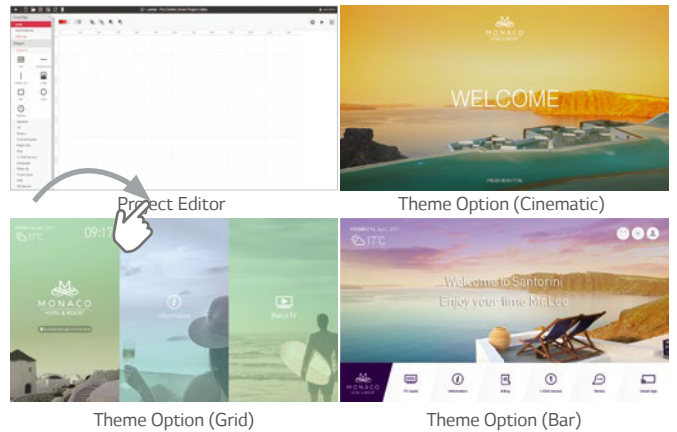

ULTRA HD TV

4K Upscaler

Enjoy Full HD content in ULTRA HD quality. The 4K Upscaler automatically upgrades Full HD content to ULTRA HD through the six steps of the upscaling processes.



Others Hospitality Features



Welcome Screen

Have a warm greeting message with your hotel name and its logo on the TV when it is turned on. The welcome screen provides an inviting, personalized experience for your guests.

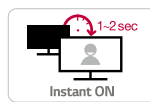

Instant On

The Instant On feature removes application boot time, so guests are immediately presented with the user interface screen when they turn on the TV.



USB Cloning

Clone all Public Display TVs with speed and ease. The USB Cloning feature allows you to simply copy and transfer TV settings from a designated master TV to all target TVs using a USB memory device.

Edge-lit Smart IPTV with Ultra HD and Integrated b-LAN™

Dimensions

43"

38.3" x 24.6" x 12.8"
(With Stand : W x H x D)

*Swivel

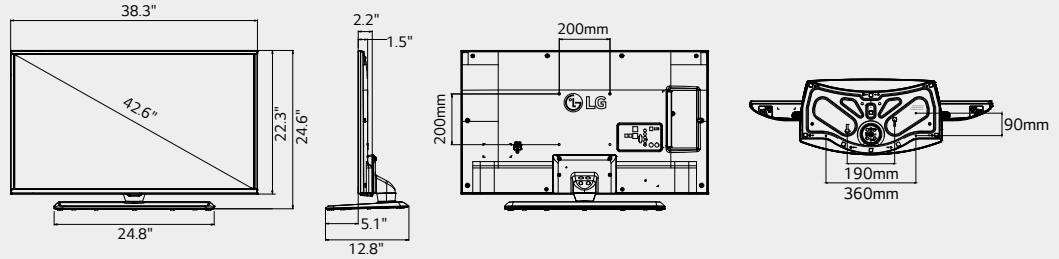

49"

43.5" x 27.6" x 12.8"
(With Stand : W x H x D)

*Swivel

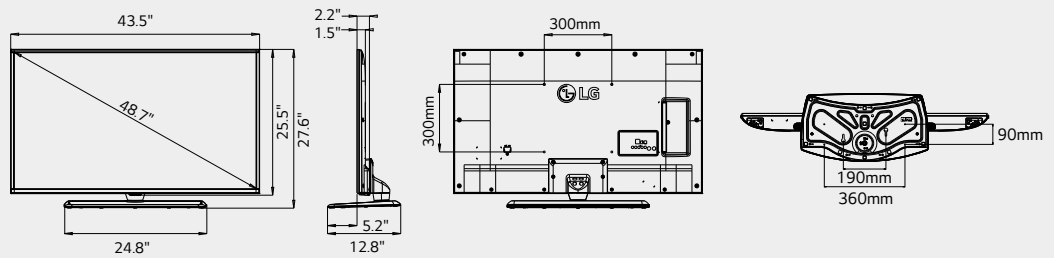

55"

48.9" x 30.7" x 12.8"
(With Stand : W x H x D)

*Swivel

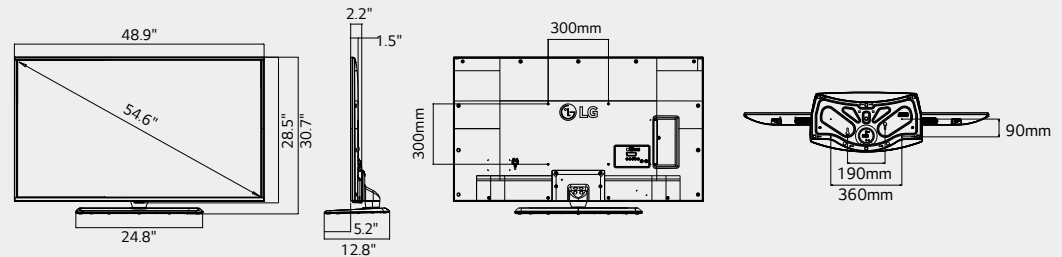

65"

57.3" x 35.7" x 12.3"
(With Stand : W x H x D)

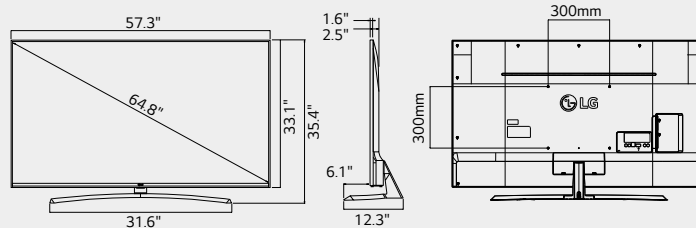

Jack Panels (Rear/Side)

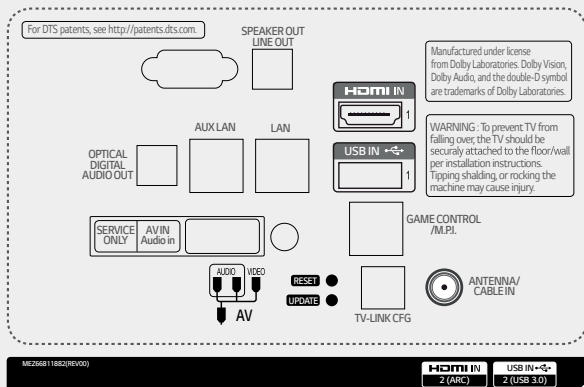

Anti-Theft System (Except 65UV770H)



Kensington Lock Slot

- LG Hotel TVs are protected by the reliable Kensington Lock solution. (Lock sold separately)



Reinforced Metal Stand

- Full metal reinforced stand to improve sturdiness, durability and safety.
- Provides (±20°) swivel out of the box.
- Provides (±20/45/90°) swivel when used with Lock Down plate.



Lock Down Plate with Credenza Hole

- Lock the TV firmly to the credenza for added security and help deter theft. (Mounting plate, security bolts, nuts and screws are included.)

Specifications

UV770H

		43	49	55	65
DISPLAY	Diagonal Size	42.8"	48.5"	54.6"	64.8"
	Type	Edge LED			
	Resolution	3,840 x 2,160 (4K UHD)			
	Dynamic Contrast Ratio	1,000,000:1			
	Static Contrast Ratio	1,200:1			
	Viewing Angle Degree	178° / 178°			
	Response Time (G to G)	8m/s			
BROADCASTING SYSTEM	Frame Rate	T120			
	Analog	NTSC			
	Digital	ATSC / VSB / Clear QAM			
VIDEO	MPEG-2 / MPEG-4 H.264 DECODING	•			
	Triple XD Engine	•			
	Real Cinema 24p (3:3 Pull down)	•			
	Picture Mode	• 10 modes (Vivid, Standard, Eco, Cinema, Sports, Game, Photo, HDR Effect, Expert (Bright Room), Expert (Dark Room))			
	Aspect Ratio	• 6 modes (16:9, Original, 4:3, Vertical Zoom, All-Direction Zoom, Just Scan)			
AUDIO	HDR	Dolby Vision™ HDR, HDR10			
	Audio Output / Speaker System	10W + 10W / 2.0ch			
	Sound Mode	• 6 modes (Standard, Cinema, Clear Voice III, Sports, Music, Game)			
	Optical Sound Sync	•			
SOLUTION	Wireless Sound Sync	•			
	Type	Pro:Centric® SMART / Pro:Centric® Direct			
	Data Streaming (IP&RF)	•			
	Pro:Centric Application	•			
	RF	2 Tuner			
	HCAP (SDK)	GEM / Flash / HTML			
	IP Return Path	•			
	Server	PCS400R, PCS200S			
SMART FEATURES	Digital Rights Management	Pro:Idiom			
	Smart UX	webOS 3.5, Commercial Smart Home, Web Browser, Pre-loaded Apps, SDP (Service Delivery Platform), Magic Remote (Optional)			
GENERAL FEATURES	Connectivity	SoftAP WiFi (802.11a/b/g/n/ac), ScreenShare (Miracast), SmartShare, DIAL, Bluetooth Sound Sync, LG Sound Sync			
	Installation	EzManager, USB Cloning			
	Management	Wake on RF, WOL (Wake on LAN) SNMP, Remote Diagnostics, MPI Protocol, IR Out, Multi IR Code, HTNG/HDMI-CEC			
	USB	Moving Picture Playback (asf, wmv, avi, mp4, m4v, mov, .3gp, .3g2, .mkv, .mpg, .mpeg, .dat, .etc), Picture (jpeg, jpg, jpe, BMP, PMG) Audio Codec (mp3, way, OGG, WMA, fl ac)			
HOSPITALITY FEATURES	Setting Option	Auto Off/Sleep Timer, Smart Energy Saving, Motion Eye care			
	Anti-theft System	Kensington Lock, Credenza/Security Screw Hole, Lock Down Plate			
INTERFACE	Side	HDMI In, USB 2.0			
	Rear	RF In (b-LAN), AV In, Digital Optical Audio Out, HDMI Input, USB, RS-232C, RJ45(2), External Speaker Out, TV Link Configuration (b-LAN Service), MPI Port, Debug			
ACCESSORIES		Power Cable (5.9 ft.), Owner's Manual / Easy Setup Guide			
DIMENSIONS	Bezel Width (L / R, U, B) : on bezel based	8.9, 8.9, 17.2 (mm)			9.1, 9.1, 17.2 (mm)
	Bezel Width (L / R, U, B) : off bezel based	5.9, 5.9, 14.7 (mm)			6.6, 6.6, 15.2 (mm)
	Vesa (mm)	200 x 200	300 x 300		
	WxHxD / weight (w/o stand)	38.1" x 22.3" x 2.4" / 22.5lb	43.3" x 25.2" x 2.4" / 28.0lb	48.7" x 28.3" x 2.4" / 33.7lb	57.3" x 33.1" x 1.7" / 52.9 lb
	WxHxD / weight (with stand)	38.1" x 24.3" x 11.9" / 29.5lb	43.3" x 27.4" x 11.9" / 35.1lb	48.7" x 30.3" x 11.9" / 40.8lb	57.3" x 35.4" x 12.3" / 56.2lb
	WxHxD / weight (Carton)	46.5" x 26.0" x 7.5" / 34.0lb	47.0" x 29.2" x 7.5" / 41.7lb	53.5" x 33.9" x 7.5" / 51.8lb	63.0" x 40.7" x 7.5" / 73.0 lb
POWER	Stand	(±20/45/90°) Swivel			
	Voltage, Hz	100 - 240V, 50/60Hz			
	Typical (Watts)	51.4	48.5	55.4	71
STANDARD APPROVAL	Stand-by (Watts)	< 0.5			
	Safety	UL			
	Environment	FCC			
UPC	Etc.	RoHS, UL, ENERGY STAR® Qualified, Dolby Vision™			
		719192611573	719192611566	719192611559	719192919877

PARTNERS



ENERGY GUIDE

Commercial Grade Stand

The estimated annual energy cost determined in accordance with 16 CFR Part 305.5 for model 43UV770H, 49UV770H, 55UV770H and 65UV770H are \$13, \$13, \$19, and \$23 respectively.

"Your energy cost depends on your utility rates and use. The estimated cost is based on 12 cents per kWh and 5 hours of use per day. For more information, visit www.ftc.gov/energy/"

FTC Television labeling rule (18 CFR Part 305, as added by 76 Fed. Reg. 1038 (Jan 6, 2011)).



Download LG Commercial Display Mobile App



Learn more www.LG.com/us/commercial

YouTube youtube.com/c/LGCommercialDisplay

All screen images are simulated. Dimension and weights are approximate. Design, features and specifications subject to change without notice.
 © Copyright 2017 LG Electronics Inc. All Rights Reserved. Pro:Centric, the "LG" logo, XD Engine are registered trademarks or trademarks of LG Electronics Inc. Pro:Idiom is a registered trademark of Zenith Electronics LLC. All other trademarks or registered trademarks are the property of their respective owners.
 SPEC_UV770H_101709_PR

