

Sleek & Practical Design Hotel TV for Various Commercial Environments

UT781H is optimized for your commercial environment with its sleek & practical design. Especially, our specially designed vertical side jack and smart solution Pro:Centric give customers useful experiences. Also, it enables creating & customizing their own content with SDK Tools, pre-loaded apps, and the content management software Pro:Centric.



Pro:Centric
Hotel TV Management Solution



Slim Design



Vertical Side Jack



Commercial Swivel Stand



Hotel TV | UT781H



* Actual product appearance may differ from the image above.

Pro: Centric Hotel Management Solution

Pro:Centric SMART offers customized services for hotel guests through an IP & RF infrastructure. With its high picture quality, sophisticated design and advanced connecting functions, it enriches in-room entertainment and increases convenience through high-end technology.

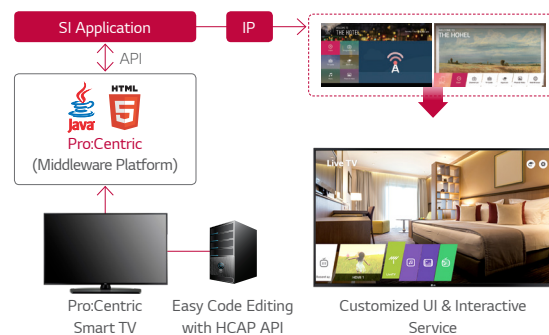

* Actual UI may differ

Pro: Centric Server Application

You can now differentiate your hotel with our customizable templates and pages. Pro:Centric provides you with a solution that is easily customizable for your business.

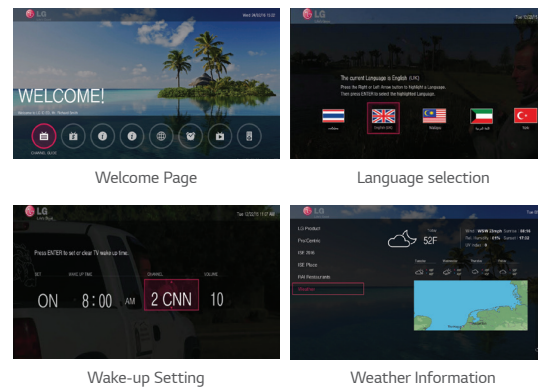

Pro:Centric Direct Solution

Pro:Centric Direct is a hotel content management system that supports simple editing tools and provides various solutions such as 1-click service and IP network-based remote management. With these solutions, users can easily edit their interface, provide customized service, and efficiently manage all TVs. P:CD version 3.0 offers IoT based in-room & voice control through LG embedded Natural Language Processing (NLP). These features will prepare hotels for the enhanced future by AI.

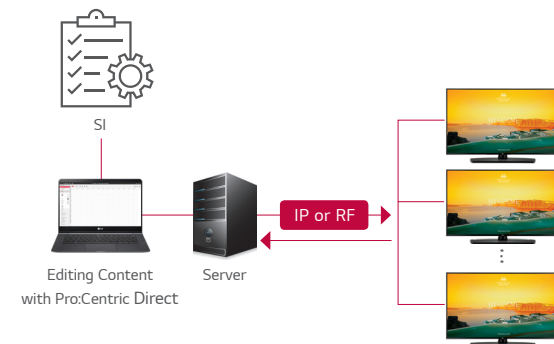

Slim Design & Vertical Side Jack

UT781H series with sleek and metallic design fits perfectly for your space. Especially, the vertical side jack optimized for business environments is specifically designed to meet customer's needs.



Commercial Swivel Stand

Expand the range of comfort for the guests with a commercial grade stand by allowing them to watch a TV from any angle.



* The configuration of jack interfaces can differ by regions.

Smart TV by LG webOS 4.5

This LG Smart TV adopts webOS 4.5. Explore the latest LG Smart TV features, and innovative technology, such as remarkable clarity, and lifelike colors.



* Actual in-screen image may slightly differ.

Voice Recognition

From seamless interaction to consistent user experience, LG is going one step further to lead the commercial TV market by voice recognition, allowing users to easily control LG TVs. Our stable and dependable solutions based on webOS and Pro:Centric Direct will significantly enhance the competitiveness of your products and services, helping you achieve a successful and fulfilling business.



- * TV Smart Control
- * Server Based control
- * Magic Motion Remote is required (sold separately)

SoftAP

Software-enabled Access Point (SoftAP) is a "virtual" Wi-Fi that uses software to create a wireless hotspot. The current version supports Bridge Mode, which enables network managers to control connected devices.



* SoftAP should be set in the installation menu after the TV is turned on.

* Smart Mirroring may not operate at the same time.

Instant On

The high speed loading system enables users to enjoy content immediately after turning on the TV.



Quick Menu

Now LG provides the new Quick menu (ver. 3.0), making it easier and more user-friendly than ever. The home menu solution has been upgraded in a big way with the addition of the new Hotel Promotional Video Creation Tool. Users can now also use Quick Manager for easy information distribution throughout the same network without a server or USB Cloning function, making perfect solution for Stand Alone Usage Scenes.

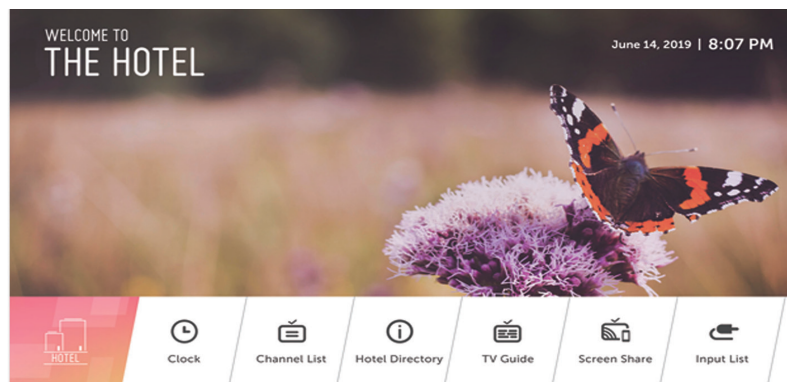

4 Templates

Welcome Video / Screen

With the capability to display repeatedly various video formats as well as images, Commercial Lite TVs allow various greeting messages in hotel rooms which make customers feel more welcome and cared for.



Conventional TV



LG UT781H

EzManager

EzManager provides convenient installation function that helps to set up Pro: Centric TV automatically without extra setting efforts. Auto-installation requires only 1~3 minutes while manual installation does 3~5 minutes.



Pro: Idiom

Prevent any illegal copying of content by the widely used DRM (Digital Right Management).



DIMENSION (unit: mm)

Hotel TV | UT781H

43"

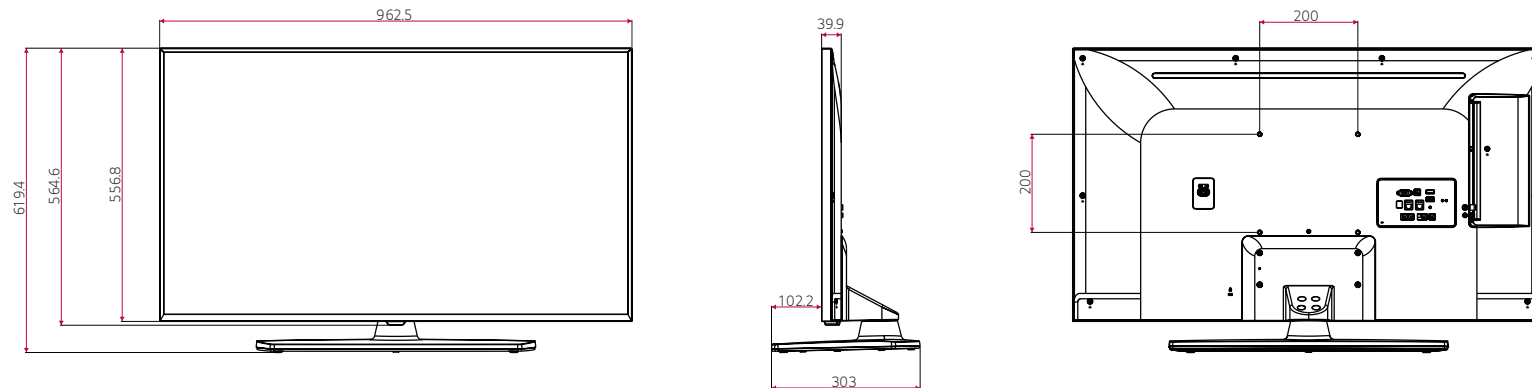

CONNECTIVITY

43"

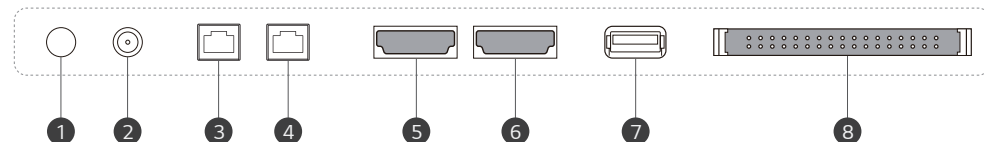
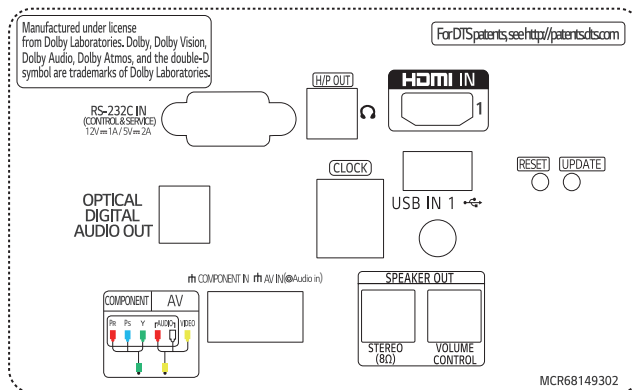

- 1 LNB SATELLITE IN
- 2 ANT. CABLE IN
- 3 AUX LAN

- 4 LAN
- 5 HDMI 2
- 6 HDMI 3

- 7 USB IN 2
- 8 PCMCIA CARD SLOT

* Specifications are subject to change without notice, so please contact LG sales team to verify before ordering.

SPECIFICATION

Hotel TV | UT781H

UT781H series (MEA)

UT781H series (MEA)		43UT781H
DESIGN	Stand Type	1 pole (Swivel)
	Front Color	Black
DISPLAY	Inch	43
	Resolution	3,840 X 2,160 (UHD)
	Brightness (cd/m ²)	350
BROADCASTING SYSTEM	Digital	DVB-T2/C/S2
VIDEO	HDR (10 Pro / HLG)	Yes / Yes
AUDIO	Audio Output	10W + 10W
	Speaker System	2.0 ch
	DOLBY ATMOS	No
	One Touch Sound Tuning	Yes
	LG Sound Sync	Bluetooth required
HOSPITALITY SOLUTION	Solution Type	Pro:Centric (Smart/Direct/V), Quick menu(3.0)
	Data Streaming (IP & RF)	Yes
	HCAP (GEM / FLASH / HTML) ※ Service Carousel (TLL / XML)	GEM / HTML5
	IP Return path	Yes
	Multicast / Unicast ready	Yes / Yes
	webRTC (Real Time Communication)	Yes
	Pro:Centric Application (version)	PCA3.8
	Pro:Centric Server	PCS400R
SMART FEATURE	DRM	Prodiom (S/W Type), Prodiom Media
	webOS 4.5, Smart Home (Launcher Bar), Quick Access, Web Browser, Pre-loaded App, SDP Server Compatibility, Magic Remote Compatibility(Ready), Clock (World Clock / Alarm), Soft AP, Wi-Fi (802.11ac, Built-in type), Screen Share (Miracast), Smart Share (DLNA (Smart Share)), LG TV Plus App Compatibility, DIAL, Bluetooth Audio Playback, LG Sound Sync/bluetooth, Mobile Connection Overlay, Voice Recognition (Standalone/Solution), IoT	
HOSPITALITY FEATURE	Hotel Mode (Installer Menu), Lock mode (Limited), Welcome Video, Welcome Screen (Splash Image), Insert Image, One Channel Map, IP Channel Manager, External Speaker Out (Int / Ext Variable/Fixed, 3.5mm, Stereo, Single ended Type(GND,L+,R+), 2W with 8Ω), Instant ON, External Power Out, V-Lan Tag, RJP (remote jack pack) Compatibility (LG/Teledapt (RS232C), Teleadapt/Guestlink (HDMI CEC)), External Clock Compatibility (LEC-005)	
MAINTENANCE FEATURE	EzManager(Simplicity), USB Cloning, Wake on RF, WOL, SNMP, Diagnostics (IP Remote), SI Compatible (TVLink Interactive), HTNG-CEC (1.4), Simplink (HDMI-CEC (1.4)), IR Out (RS-232C, HDMI), Multi IR Code	
JACK INTERFACE	Set Side	RF In 2, HDMI In 2 (2.0), USB (2.0), RJ45 (Usage Purpose) 2 (Ethernet, Aux), CI Slot
	Set Rear	HDMI In (HDCP 2.0), USB (2.0), Headphone Out, AV In (Phone Jack Type), Component in (YPbPr-Video (Phone Jack Type)), Digital Audio Out (Optical), RS-232C(D-Sub 9pin, Control & Service), Clock Interface (RJ12), External Speaker Out(3.5mm phone jack) 2 (Spk-out 1, 4W (Stereo, R: 2.0W, L: 2.0W, 8Ω) Vol. Control 1)
DIMENSION (UNIT : mm / kg)	VESA	200 x 200
	W x H x D / Weight (with stand)	962.5 x 619.4 x 303 / 14.4
	W x H(H') x D / Weight (without stand)	962.5 x 564.6 x 39.9 / 11.3
	W x H x D / Weight (Shipping)	1,147 x 660 x 190 / 16.6
POWER (UNIT : WATTS)	Voltage, Hz	AC 220~240 V, 60Hz
	Power Consumption(Typ.)	TBD
	Stand-by	TBD

* Specifications are subject to change without notice, so please contact LG sales team to verify before ordering.