

Specifications

		MS75A-7BB
PANEL	Screen Size	49"
	Panel Technology	IPS
	Aspect Ratio	16:9
	Native Resolution	1,920 x 1,080 (FHD)
	Brightness	600 cd/m ² (700 cd/m ² without mirror glass)
	Response Time	8 ms (G to G BW) typ.(TBD)
	Surface Treatment	Hard coating (3H), Anti-glare treatment of the front polarizer (Haze 10%)
	Guaranteed Operation Hours	24 Hrs
	Orientation	Portrait & Landscape
CONNECTIVITY	Input	HDMI, HDMI/OPS, DP, DVI, Audio, USB
	Output	DP, External Speaker
	External Control	RS232C in/out, RJ45 in, IR&Light sensor, Pixel sensor
PHYSICAL SPECIFICATION	Color	Black
	Bezel Width	8.4 mm (Even Bezel)
	Monitor Dimension (W x H x D)	1,095.0 x 625.2 x 37.3 mm
	Weight (Head)	22.0 kg
	Monitor with Optional Stand Dimensions (W x H x D)	1,095.0 x 699.9 x 298.3 mm
	Weight (Head+Stand)	23.4 kg
	Carton Dimensions (W x H x D)	1,330 x 810 x 174 mm
	Packed Weight	25.3 kg
	VESA™ Standard Mount Interface	400 x 400 mm
SPECIAL FEATURES	Temperature Sensor, Auto Brightness sensor, Tile Mode (Up to 15x15), Natural Mode @Tile Mode, DPM Select, Energy Saving, Smart Energy Saving, File Play with USB, Internal Memory (16GB), Wi-Fi dongle ready	
ENVIRONMENT CONDITIONS	Operation Temperature	0°C to 40°C
	Operation Humidity	10 % to 80 %
POWER	Power Supply	100-240V~, 50/60Hz
	Power Type	Built-In Power
POWER CONSUMPTION	Typ. / Max	125 W / 175 W
	Smart Energy Saving	95 W
STANDARD (CERTIFICATION)	Safety	UL / cUL / CB / TUV / KC
	EMC	FCC Class "A" / CE / KCC
MEDIA PLAYER COMPATIBILITY	OPS Type Compatible	No
	External Media Player Attachable	Yes (MP500/MP700), KT-OPSA
SOFTWARE COMPATIBILITY	Content Management Software	SuperSign W
	Control and Monitoring Software	SuperSign C
ACCESSORY	Basic	Remote Controller (include battery 2ea), Power Cord, IR/Light Sensor Receiver, CD (Owner's Manual), HDMI Cable
	Optional	SP-2100, ST-200T, LSW440S, AN-WF500 (Wi-Fi USB dongle), KT-OPSA (OPS Kits), KT-SPO
	Glass Coating	Transmittive Ratio: 49.0 ± 5% / Reflective Ratio: 50.0 ± 5%
MIRROR	Transmission Color Coordination	x=0.310 ±0.03, y=0.330 ±0.03 (D65)
	Reflection Color Coordination	L*= 77 ±3, a*=1.0 ±3, b*= 0.0 ±5
	Glass Thickness	2.8T
	Software Feature	Screen Off Mode

Mirror Display for Specialized Showcasing

Mirror signage MS75A-7BB



MS75A-7BB is a mirror signage, which provides normal mirror functions and multimedia services at the same time. It is recommendable for places where both mirrors and information displays are necessary, such as clothing stores and hair shops. In addition, MS75A-7BB is the best choice for good interior design since it only takes up the minimum space replacing a mirror.

Key Features

Built-in Mirror

Installation Convenience

No need for additional installations.

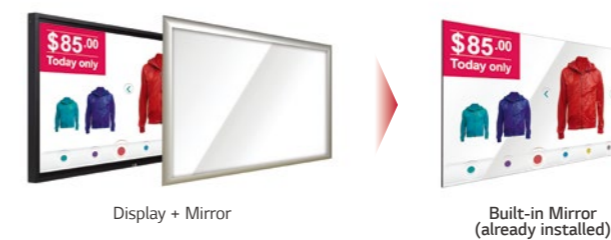

Add Creative Options

Use sensors and content for maximum exposure. Add multi-touch, proximity sensors and gestures tailored to the integrator/content provider.

- increases content exposure
- customized to each retail environment

Convenient Management

No Extra Media Player

Since it is possible to operate the signage without a separate media player, it is easy to install and reduce total cost of ownership.



Stand-by Screen

Even without signal from the media player, the network does not turn off completely, so remote control is possible, which prevents unnecessary power usage and enables efficient management.



Download LG Commercial Display Mobile App



Learn more www.lg.com/b2b

YouTube [youtube.com/c/LGCommercialDisplay](https://www.youtube.com/c/LGCommercialDisplay)

LG may make changes to specifications and product descriptions without notice. Copyright © 2017 LG Electronics Inc. All rights reserved. "LG Life's Good" is a registered trademark of LG Corp. The names of products and brands mentioned here may be the trademarks of their respective owners.



Mirror Display for Specialized Showcasing

Mirror signage MS75A-7BB



Screen Sizes
49"

MS75A-7BB

- Built-in Mirror
- Brightness: 600 cd/m²
- Bezel: 8.4 mm (Even bezel)
- Depth: 37.3 mm
- Interface : HDMI, HDMI/OPS, DP, DVI, RS232C, RJ45, USB

IPS SUPERSIGN™ webOS

Other Features

Remote Management

Simple Network Management Protocol

SNMP support ensures convenient network management

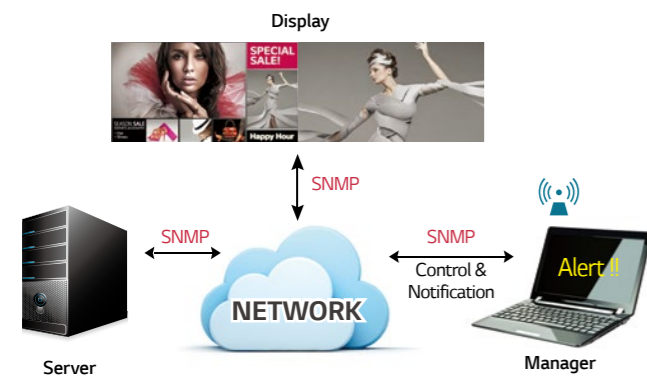

Wi-Fi Support

MS75A-7BB support wi-fi usb dongle connection for convenient content distribution.



Application

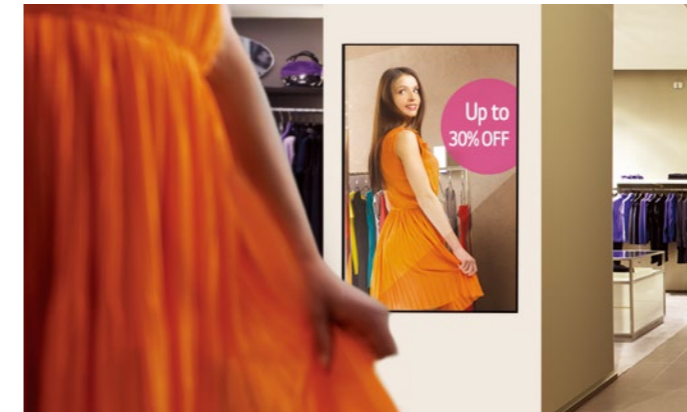

FASHION

- Venue : Fitting room, Store
- Virtual fitting, Recommended clothing, View purchasing legacy



HOTEL

- Venue : Lobby, Elevator, Bathroom
- Display Hotel information, Advertisement



BEAUTY

- Venue : Hair salon, Cosmetic
- View hairstyle legacy, Recommended hairstyle, Display virtual hairstyle simulation, Target marketing (Ads)



FITNESS

- Venue : Gym, Fitness Center
- Customized exercise program, Virtual training

Supportive Convenience

Simple Customization

SI can easily develop programs suitable for signage by providing a set of commands (SDK) for WebOS, the basic platform of Signage.



*SDK : Software Development Kit

OPS Compatibility

Compatible with the Open Pluggable Specification (OPS), users have the flexibility to choose their appropriate media player.

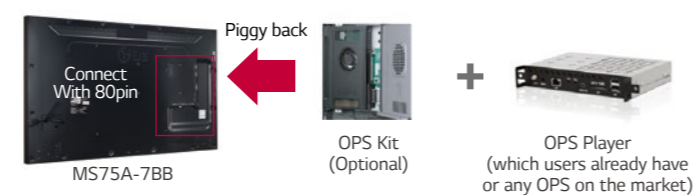

Dimensions

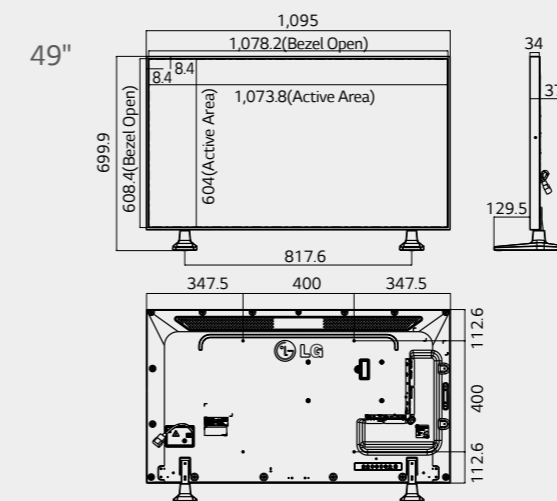

Connectivity

- | | | |
|----------------|-------------------|---------------|
| 1 SPEAKER OUT | 6 HDMI 2/OPS | 11 USB |
| 2 AUDIO IN | 7 IR&LIGHT SENSOR | 12 RS232C IN |
| 3 LAN | 8 DP IN | 13 RS232C OUT |
| 4 PIXEL SENSOR | 9 DP OUT | |
| 5 HDMI 1 | 10 DVI | |

