

MICRO HOME THEATER SYSTEM

LFD750



- 160 Watts Total Power
- Progressive Scan Output
- Made for iPod
- USB Media Plus
- 3-Way Stereo Speakers
- Touch Panel Controls
- AM/FM Radio Tuner
- DVD/CD Playback

160W TOTAL POWER

Powerful sound with 160 watts of total output power.

PROGRESSIVE SCAN OUTPUT

Progressive scan DVD playback.

MADE FOR IPOD

Connect, control and play directly from your iPod.

USB MEDIA PLUS

Experience your digital music, photo and video library with USB Media Plus.

3-WAY STEREO SPEAKERS

High audio fidelity with stereo detachable 3-way speakers and side-woofers.

TOUCH PANEL CONTROLS

Stylish and simple to use touch panel volume control.



reddot design award
winner 2007



www.LGusa.com

MICRO HOME THEATER SYSTEM

LFD750

AMPLIFIER/SPEAKER

Output Power - Front	80W x 2*
Speaker Type	Book Shelf Type 2 Ch Speaker
Frequency Response	60 - 20000Hz

AUDIO/VIDEO PLAYBACK FORMATS

Disc Capacity	1
DVD (PAL)	•
DVD (NTSC)	•
DVD-R	•
DVD-RW	•
CD-R/RW	•
DVD+RW	•
CD-R/RW	•
MP3 Audio	•
WMA Audio	•
JPEG Photo	•
DivX Video	•
MPEG4 Video	•
Music Photo Album	•

GRAPHIC USER INTERFACE

Initial Menu Language	English
Available Menu Languages	English/Spanish/French

VIDEO CAPABILITIES

Video Digital/Analog Conversion (DAC)	27MHz/10bit
Video Output Resolutions	480i/480p
Progressive Scan	•

AUDIO CAPABILITIES

Audio Digital/Analog Conversion (DAC)	192kHz/24bit
S/N Ratio	More than 75dB (1kHz)
XPS Pro (eXtreme True Sound Pro)	•
Sound Modes - 2 Channel (DSP)	13
Sound Modes - 5.1 Channel (DSP)	4
DTS Decoding	•
Dolby Digital 5.1 Channel Decoding	•
Dolby Prologic II	•
Dolby Digital 2 Channel Down-Mix	•
DRC (Dynamic Range Control)	•

DVD PLAYBACK FEATURES

Screen Fit	•
Zoom	•
Parental Lock	•
Chapter Skip (Rew/Fwd)	•
Search/Slow/Step Skip for Rew and Fwd	•
1.5x Playback with Audio/Video	•
Bookmark Search	•
Resume	•
A-B Repeat Play	•
Closed Caption	•
Vocal On/Off	•

CD PLAYBACK FEATURES

Programmable Play	•
Random Play	•
Repeat Play	•
Number of Programmable Tracks	300
JPEG Preview	•
MP3 ID3 Tag Support	•

USB MEDIA HOST/PLUS PLAYBACK

JPEG	•
MPEG1	•
MPEG2	•
MPEG4	•
WMA	•
DivX®	•
MP3	•
MP3 VBR	•

TUNER

Audio Tuner Band	FM/AM
FM Tuner Range (100kHz)	87.50-108.00MHz(50kHz)
AM Tuner Range (10kHz)	530-1720kHz
Radio Tuner Presets	50

FRONT PANEL INPUTS/OUTPUTS

Microphone Input	2
Headphone Jack	1
USB (A) Port	1

REAR PANEL INPUTS/OUTPUTS

Audio (L/R) In	1
Component Video Out	1
Composite Video Out	1
FM Antenna Input	1
AM Antenna Input	1
Speaker Output Type/Number	Push-in/2
LG Made for iPod Connector Port	1

SUPPLIED ACCESSORIES

Remote Control Type	Universal
A/V Cable (RCA Type)	•
LG Made for iPod Connector Cable	•
Battery (Size)	(AAA)
User Manual	•
QSG English (Quick Start Guide)	•
Warranty Card	•
Customer Registration Card	•
FM Antenna	•
AM Antenna	•

SPECIAL FEATURES

Screen Saver	•
Auto Power Off	•
Demo Mode	•

SPECIFICATIONS

Front Panel Display	Flourescent
Cabinet Color	Glossy Black
Main Unit Dimensions (W x H x D)	6.7" x 9.0" x 10.2"
Front Speaker Dimensions (W x H x D)	5.1" x 11.6" x 9.5"
Main Unit Weight	7.3 lbs
Front Speaker Weight (Each)	9.0 lbs
Dimensions w/Packaging (W x H x D)	12.6" x 14.1" x 19.3"
Weight In Package	33.0 lbs.
UPC	N/A
Warranty	1 Year Parts/90 Days Labor

*Rated at 1kHz into 4 ohms, 10% THD

REMOTE



REAR AUDIO/VIDEO INPUTS/OUTPUTS

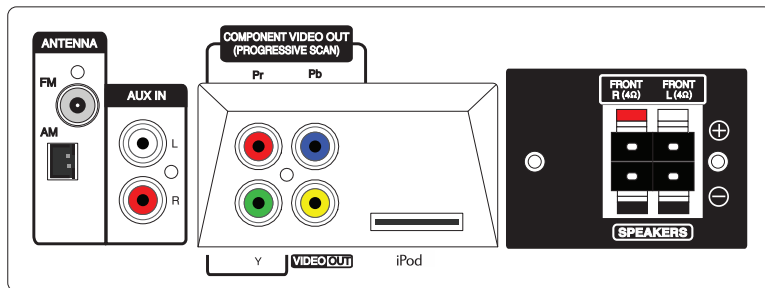

FRONT



LG Electronics U.S.A., Inc. 1000 Sylvan Avenue, Englewood Cliffs, NJ 07632 (800)243-0000

© 2008 LG Electronics U.S.A., Inc., Englewood Cliffs, NJ. LG Design and Life's Good are trademarks of LG Electronics, Inc. All other trademarks are the property of their respective owners. Design and specifications subject to change without notice. 02/06/08

www.LGusa.com